

DETAILS

Product Number	C14165_STRADA-2X2-ME-WIDE2
Family	Strada-Module
Type	Lens
Color	clear
Diameter	50x50 mm
Height	7 mm
Style	square
Optic Material	PMMA
Holder Material	
Fastening	pin, screw
Status	production ready
ROHS Compliant	Yes
Date Updated	21/04/2016



OPTICAL PROPERTIES

LED	Viewing Angle	Light Beam	Efficiency	cd/lm	Connector
XP-G2	Asymmetric deg	Streetligh...	79 %	0.800	Undefined Manufacturer: Protective Plate, Glass
XP-L	sim: Asymmetri	Streetligh...	sim: 90 %	sim: 0.660	-
XP-G3	Asymmetric deg	Streetligh...	84 %	0.690	-
XP-L2	Asymmetric deg	Streetligh...	83 %	0.510	-
XHP35 HD	sim: Asym	Streetligh...	sim: 94 %	sim: 0.520	-
H35C1 (LEMWA33)	Asymmetric deg	Streetligh...	84 %	0.770	-
NVSW3x9A	Asymmetric deg	Streetligh...	85 %	0.680	-
Duris S8	sim: Asymmetri	Streetligh...	sim: 93 %	sim: 0.600	-
Oslo Square Gen3	sim: Asymmetri	Streetligh...	sim: 92 %	sim: 0.890	-
Fortimo FastFlex LED board 2x8 DA G4	asymmetric deg	Streetligh...	86 %	0.860	Undefined Manufacturer: Protective Plate, Glass
LH351B	Asymmetric deg	Streetligh...	94 %	0.850	-
LH351D	sim: asym	Streetligh...	sim: 75 %	sim: 0.410	Undefined Manufacturer: Protective Plate, Glass
TL1L4	Asymmetric deg	Streetligh...	81 %	0.750	Undefined Manufacturer: Protective Plate, Glass
RLE G1 49x223mm 4000lm xxx EXC OT	Asymmetric deg	Streetligh...	94 %	1.300	-
RLE G1 49x245mm 4000lm xxx EXC OT	Asymmetric deg	Streetligh...	94 %	1.300	-
RLE G1 49x121mm 2000lm xxx EXC OT	Asymmetric deg	Streetligh...	94 %	1.300	-
RLE G1 49x133mm 2000lm xxx EXC OT	Asymmetric deg	Streetligh...	94 %	1.300	-

D

C

B

A

4

4

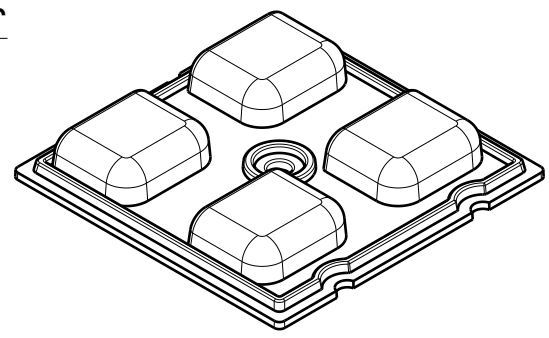
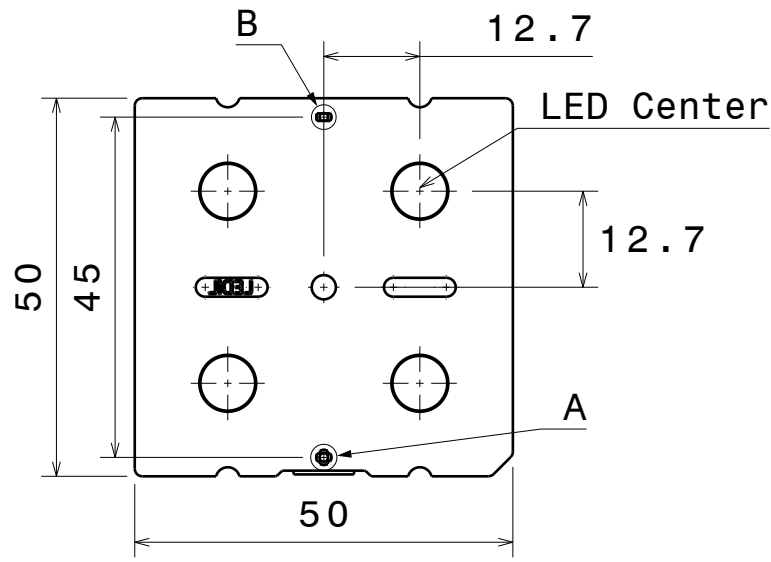

3

3

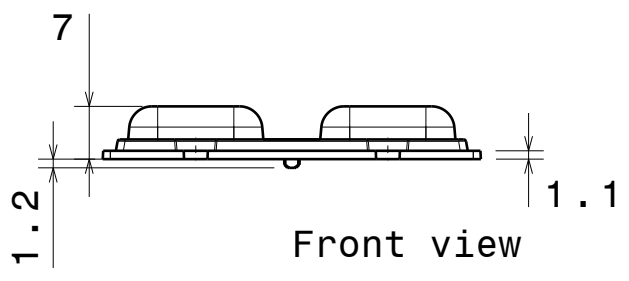

2

2

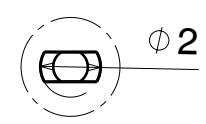
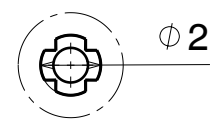
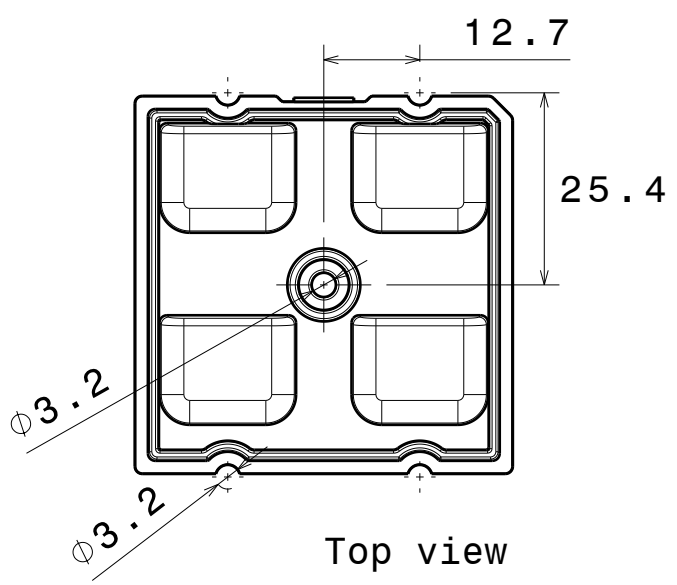

Tolerances if not otherwise shown
 According to DIN ISO 2768-1
 Linear measures:
 Up to 30mm class M, otherwise class C.
 According to DIN ISO 2768-2
 Form and position: class L

LEDiL LediL Oy
 Salorankatu 10
 FIN 24240 SALO
 Finland

THIRD ANGLE PROJECTION:

DRAWING TITLE
STRADA-2X2-ME-WIDE2

This drawing is the property of LEDiL Oy. It may not be reproduced, copied or communicated without a written agreement with LEDiL Oy.

SIZE	PART NUMBER
A4	C14165

SCALE	1:1	WEIGHT	-	SHEET	1/1
-------	-----	--------	---	-------	-----

D

A

1

1

Luminaire: LEDiL Oy C14165_STRADA-2X2-ME-WIDE2 (XP-G2)
Lamps: 1 x CREE_XP-G2_2x2_(XPGBWT-L1-000-00G51)
_407.74lm@250mA_CCT=7181K_P=2.95432W_I=249.9mA

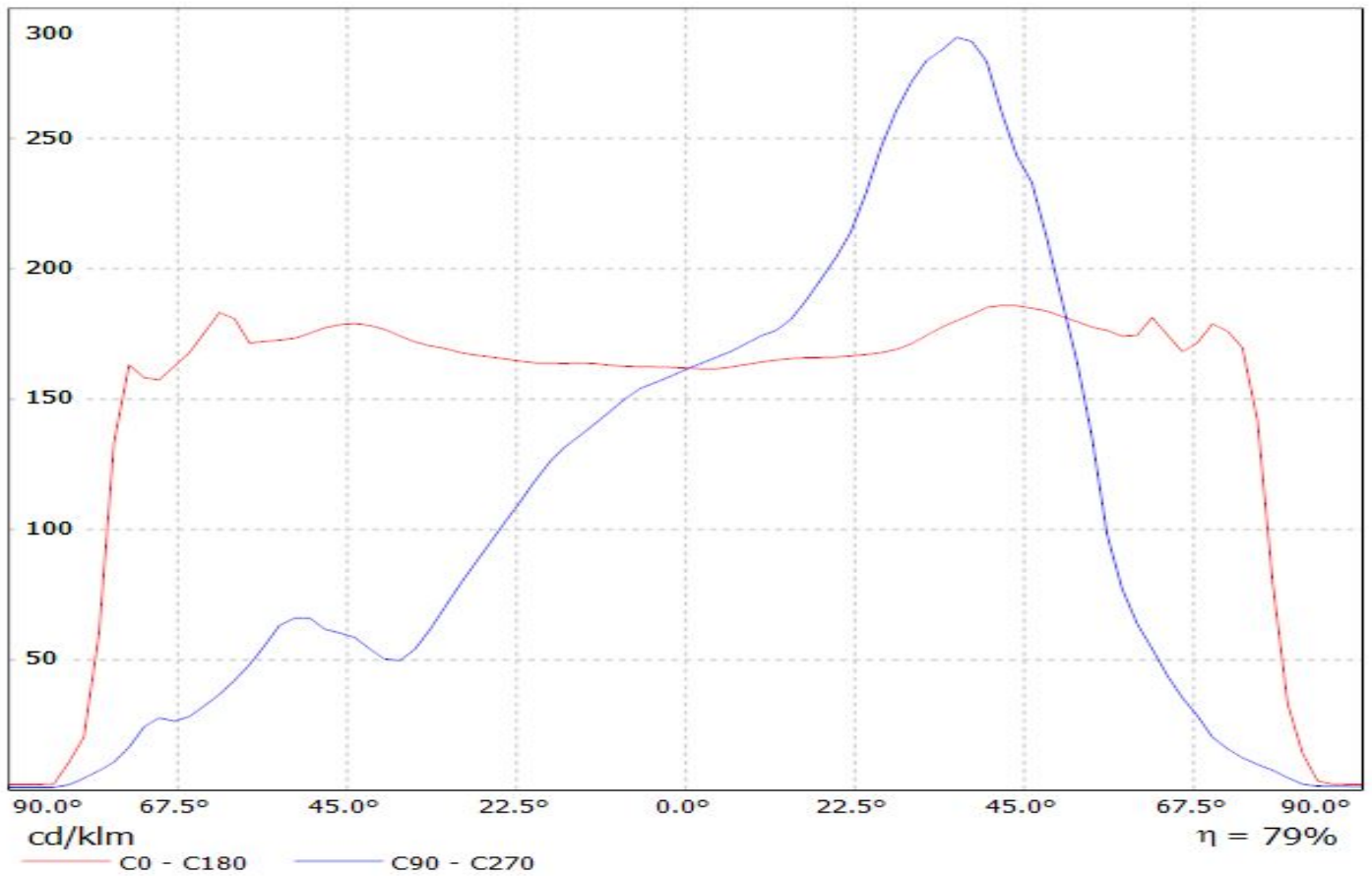

Luminaire: Ledil Oy C14165_STRADA-2X2-ME-WIDE2_(XP-L)_SIMULATED
Lamps: 1 x Cree XP-L

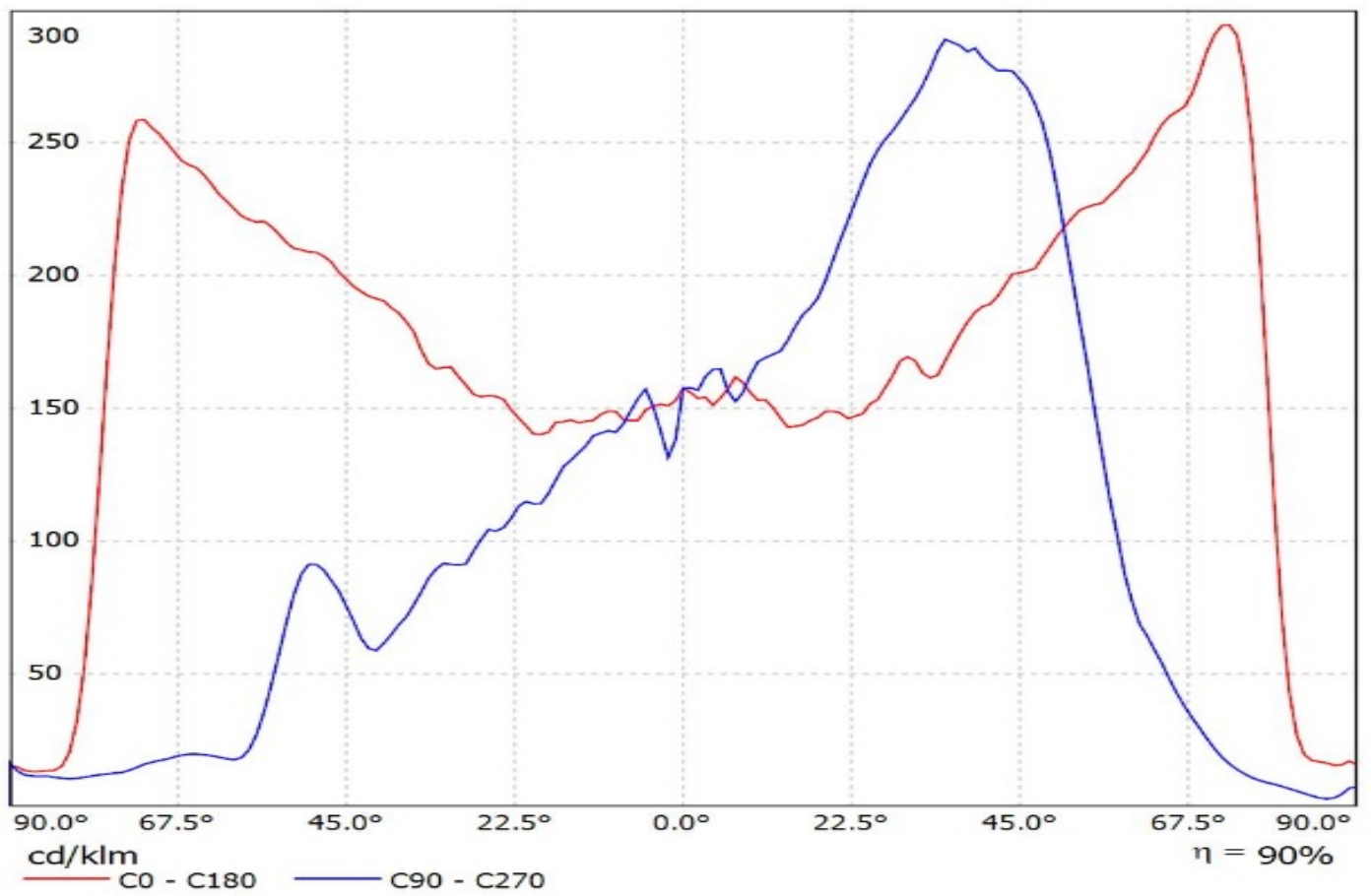

Luminaire: Ledil C14165_STRADA-2X2-ME-WIDE2_(XP-G3)_withglass
Lamps: 1 x Cree_XP-G3_2x2_(XPGDWT-B1-3C0-S4-0-01)_516.212lm@250mA_P=2.78875W_I=0.250A

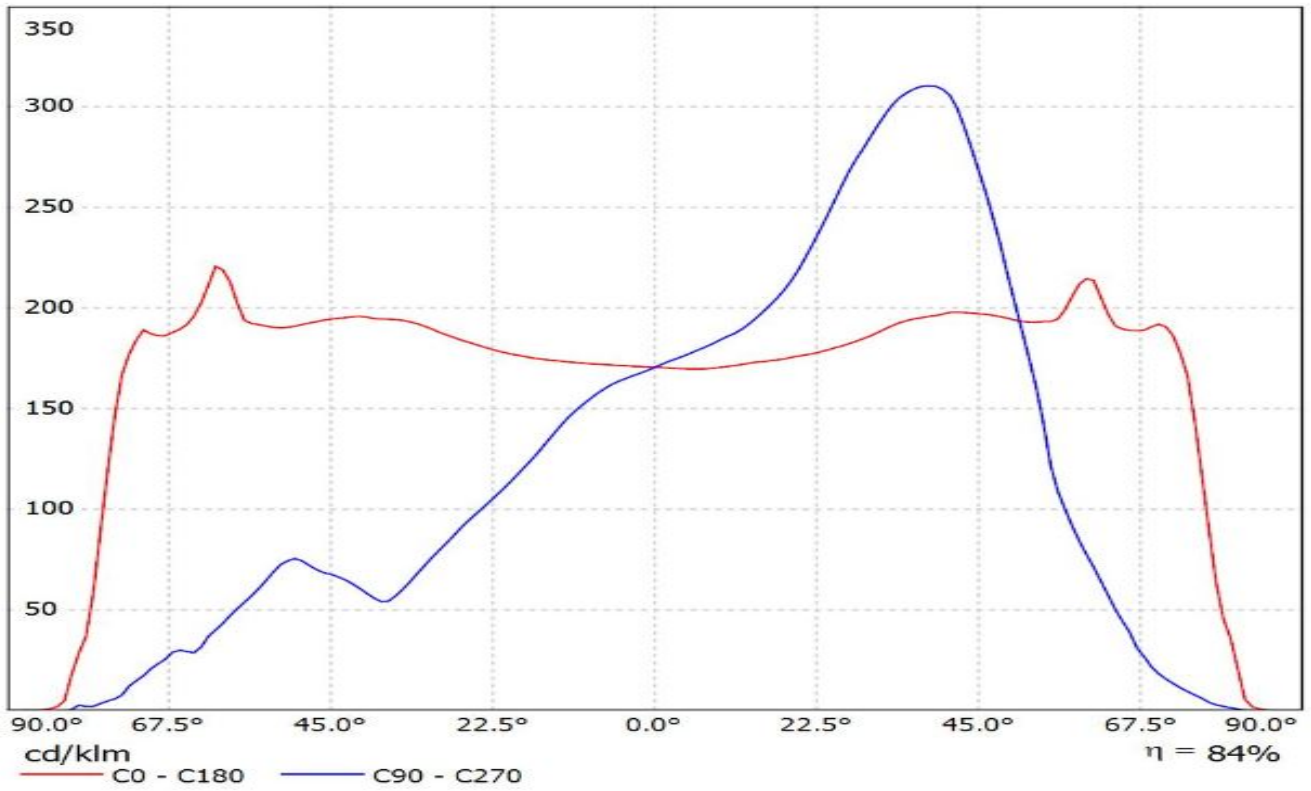

Luminaire: Ledil C14165_STRADA-2X2-ME-WIDE2_(XP-L2)

Lamps: 1 x Cree_XP-L2_2x2_(XPLBWT-00-0000-000BV50E3)550.93lm@250mA_P=2.7815W_I=0.25A

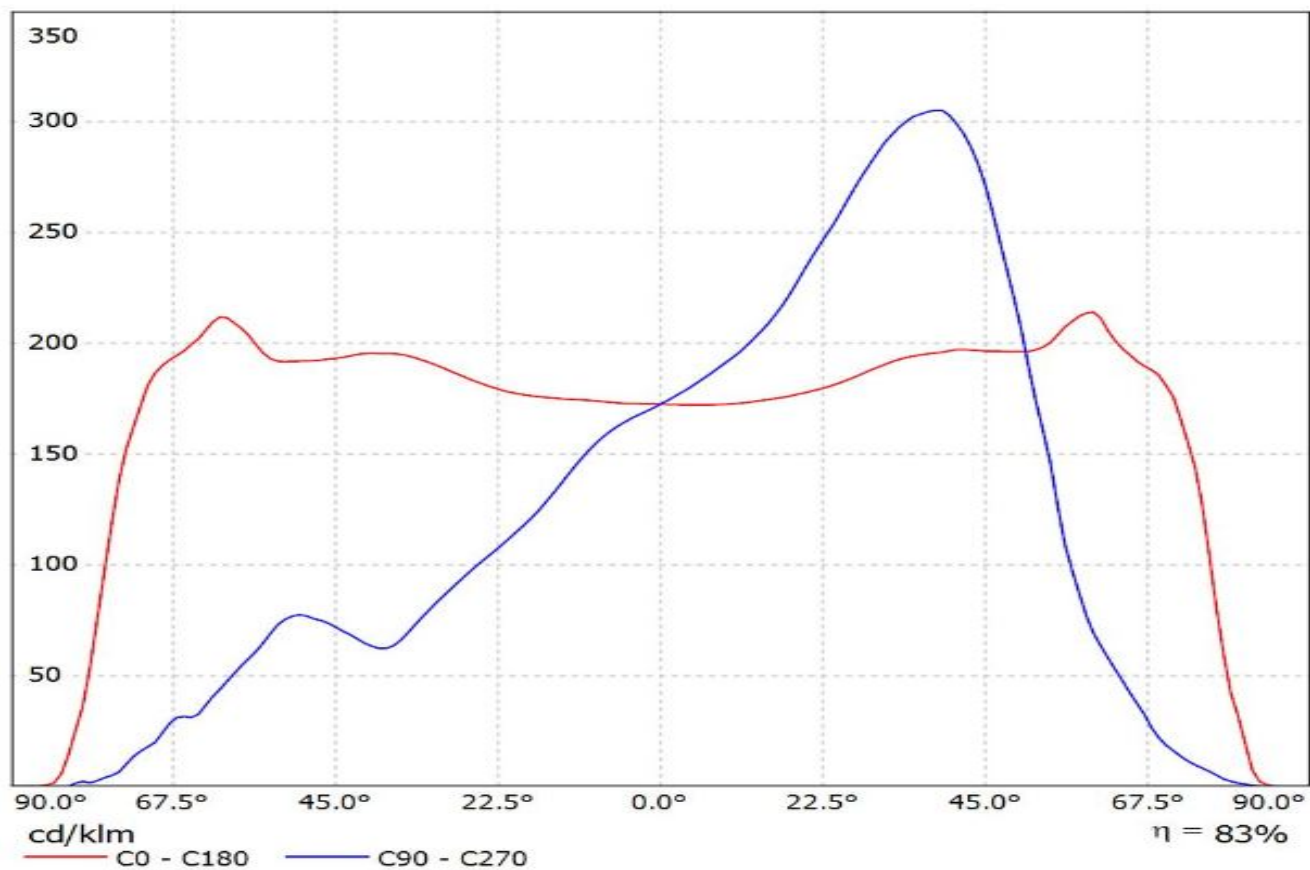

Luminaire: Ledil Oy C14165_STRADA-2X2-ME-WIDE2_(XHP35_HD)_SIMULATED
Lamps: 1 x Cree XHP35 HD

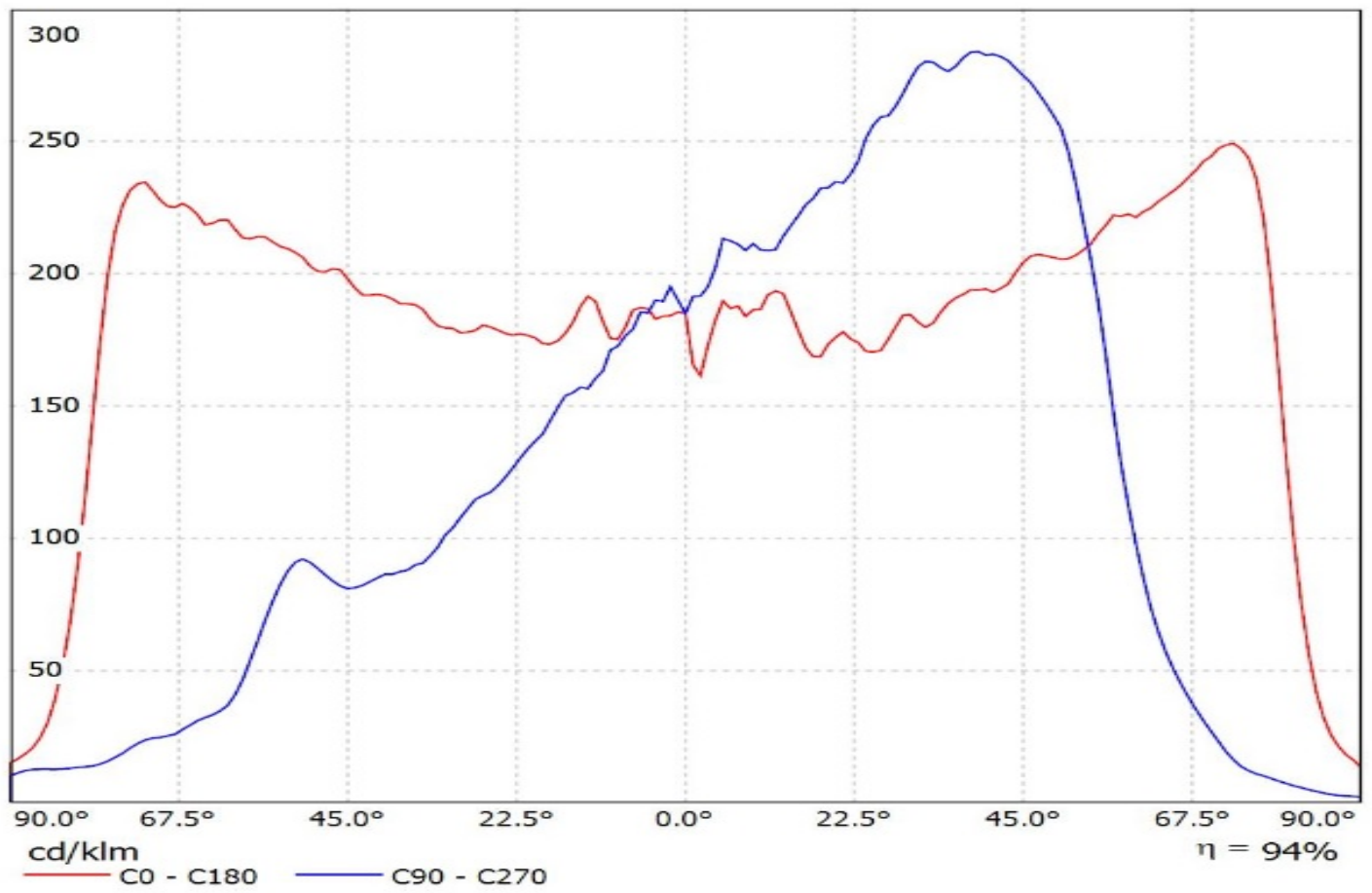

Luminaire: Ledil C14165_STRADA-2X2-ME-WIDE2_(H35C1)_withglass
Lamps: 1 x LG_H35C1_2x2_477.216lm@250mA_P=2.87475W_I=0.250A

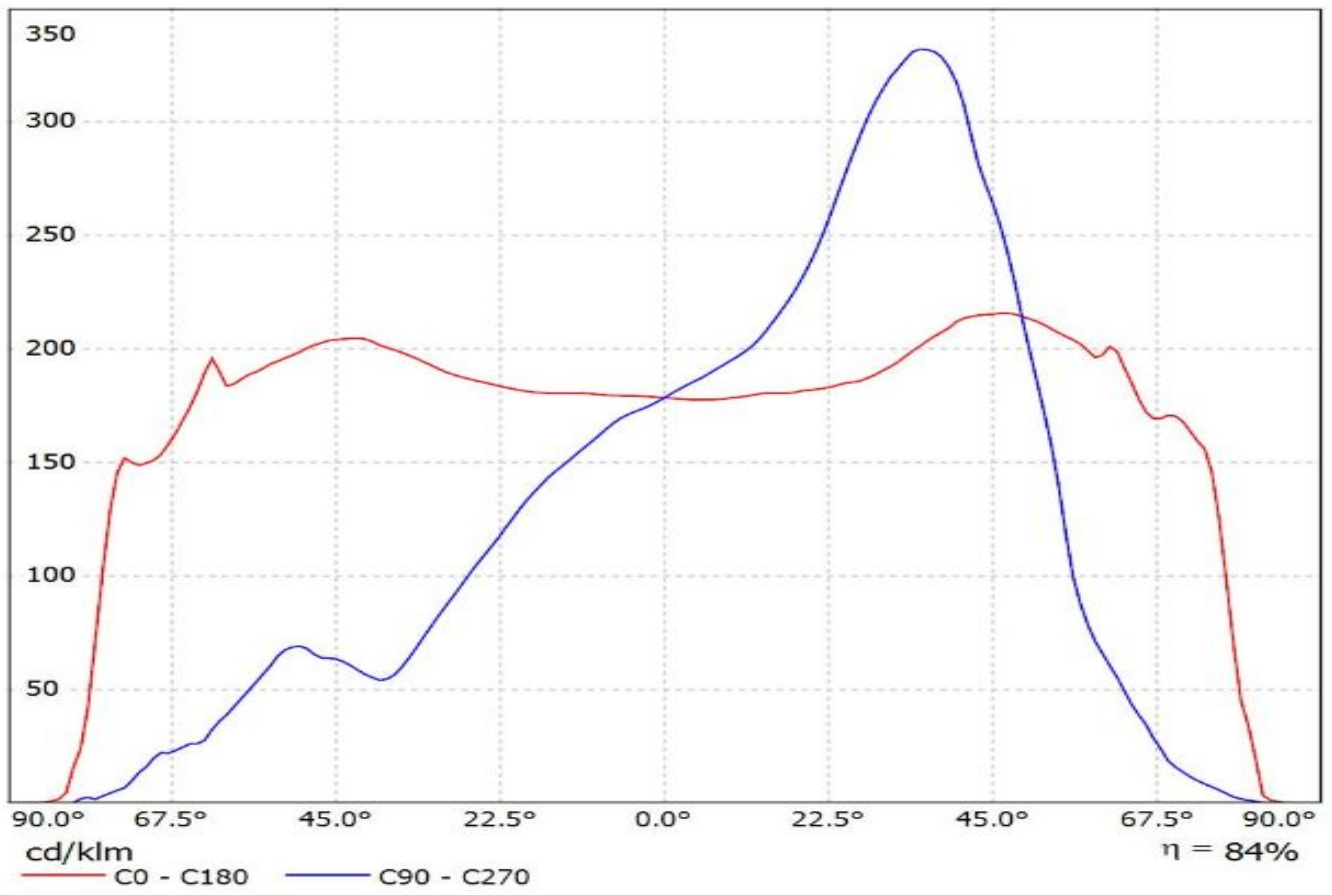

Luminaire: LEDiL Oy C14165_STRADA-2X2-ME-WIDE2_(NVSW319AE)
Lamps: 1 x Nichia_NVSW319AE_499.093lm@250mA_P=2.79052W_I=0.25A

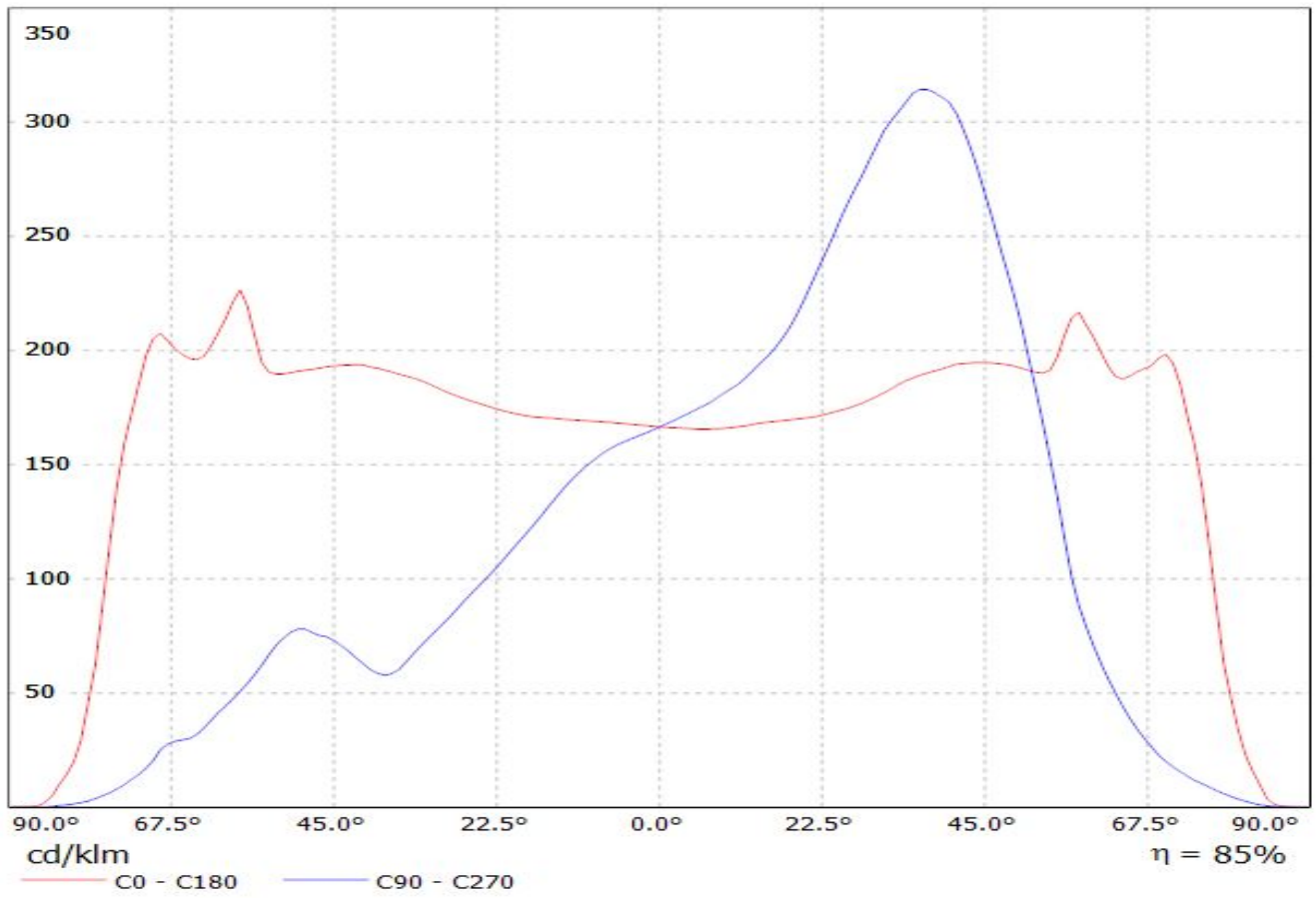

Luminaire: Ledil Oy C14165STRADA-2X2-ME-WIDE2_(Duris_S8_Gen2)_SIMULATED
Lamps: 1 x OSRAM_DURIS S8 GEN2 5050 package

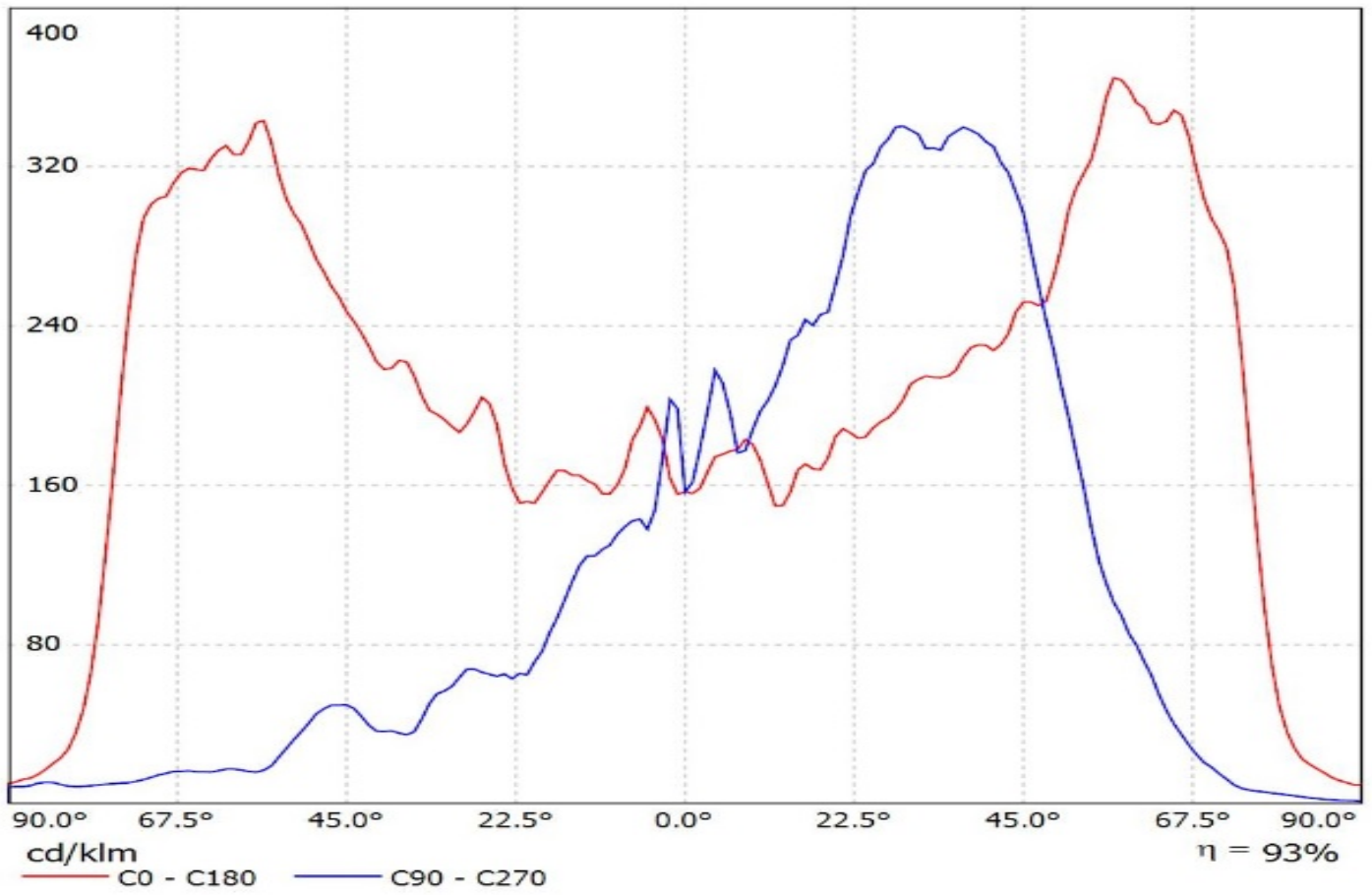

Luminaire: Ledil Oy C14165_STRADA-2X2-ME-WIDE2_(Oslon_Square_Gen3)_SIMULATED
Lamps: 1 x Osram Oslon Square Gen3 (GW CSSRM2.PC)

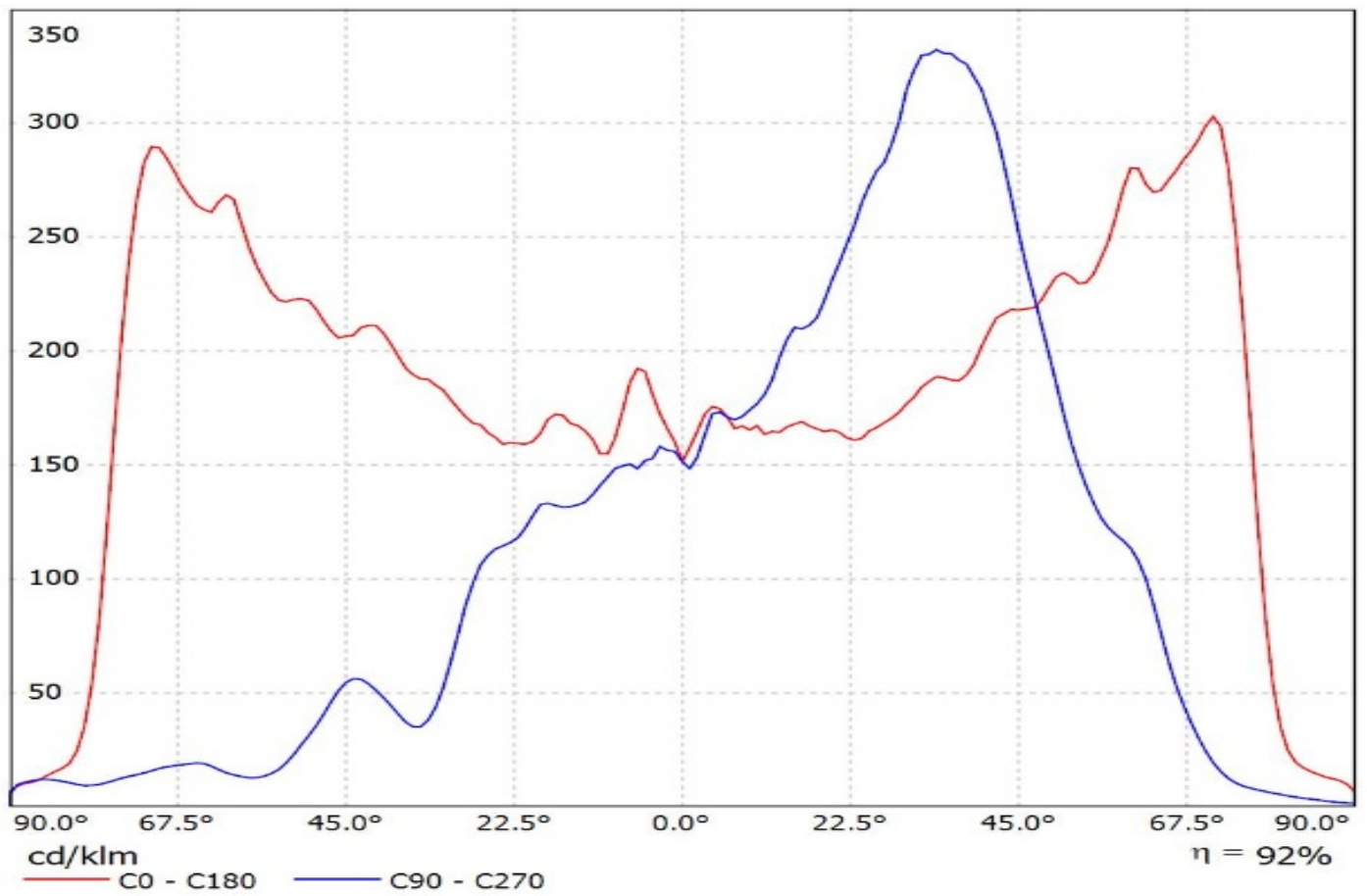

Luminaire: LEDiL Oy C14165_STRADA-2X2-ME-WIDE2 (Fortimo_F-Flex_2x8_740DAG3)_glass
Lamps: 1 x Philips_Fortimo_FastFlex_LED_board_2x8_740_DA_G3_(Glass_chassis)_1774.78lm@250mA_P=11.5852W_I=0.2498A

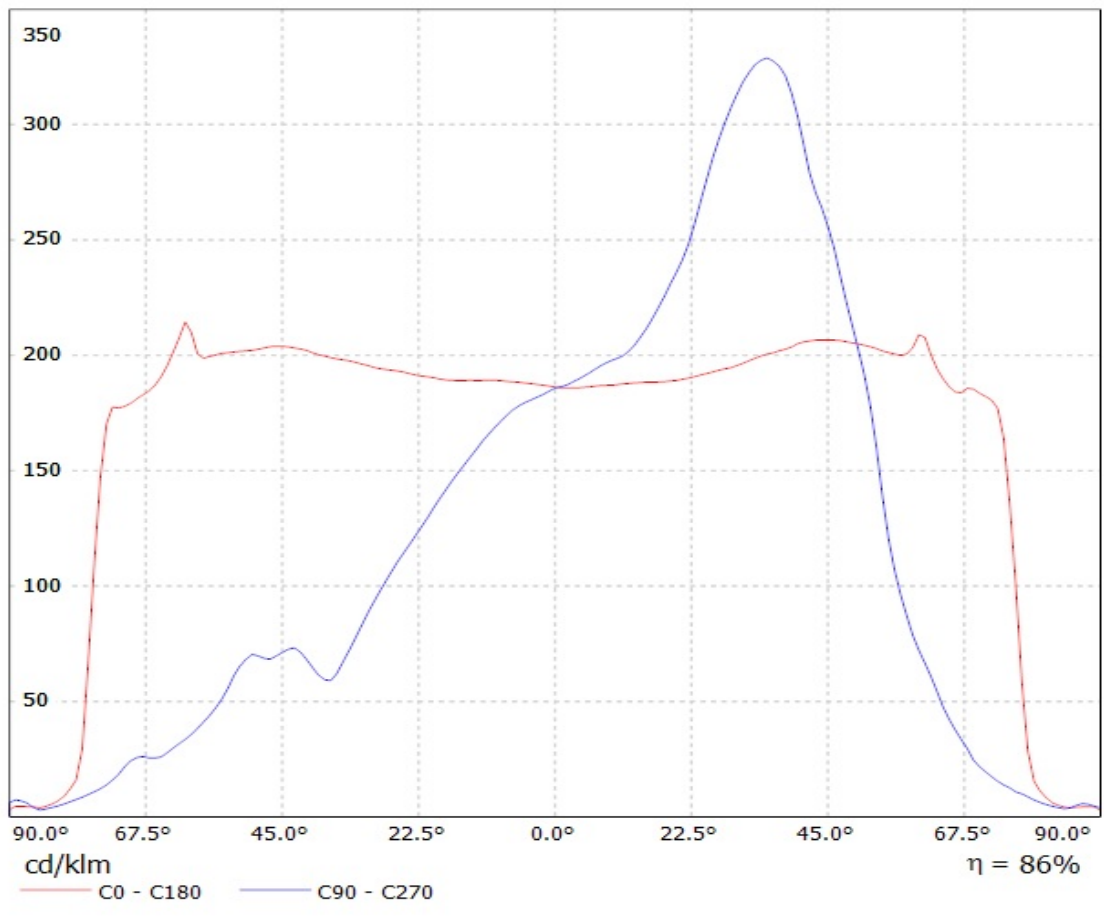

Luminaire: Ledil C14165_STRADA-2X2-ME-WIDE2_(LH351B)
Lamps: 1 x Samsung_LH351B_2x2_442.633lm@250mA_P=2.851W_I=0.25A

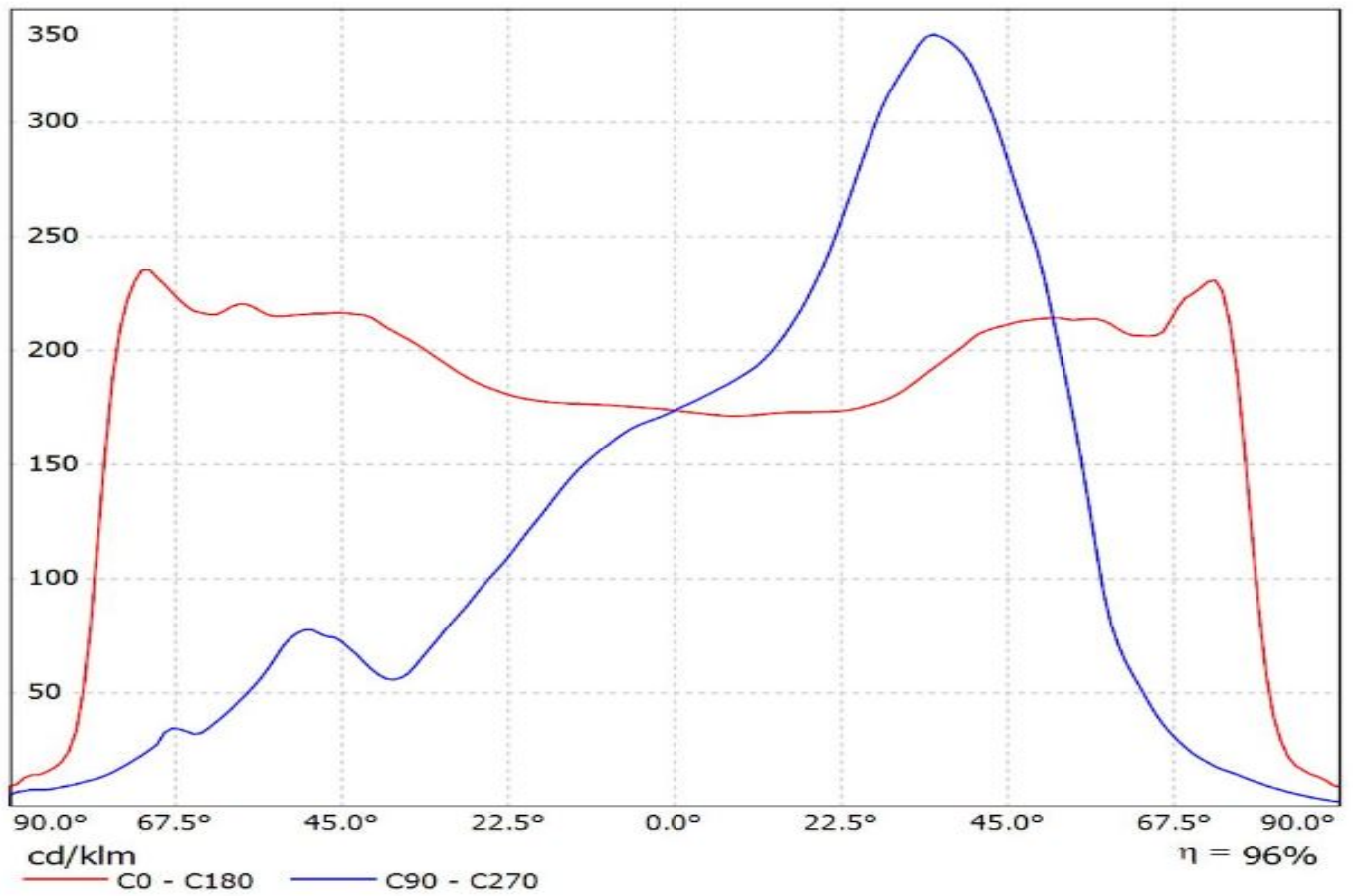

Ledil C14165_STRADA-2X2-ME-WIDE2_(TL1L4)_glass / LDC (Linear)

Luminaire: Ledil C14165_STRADA-2X2-ME-WIDE2_(TL1L4)_glass

Lamps: 1 x Toshiba_TL1L4_2x2_(TL1L4-DW0)_444.089lm@250mA_CCT=6500K_P=2.9W_I=0.25A

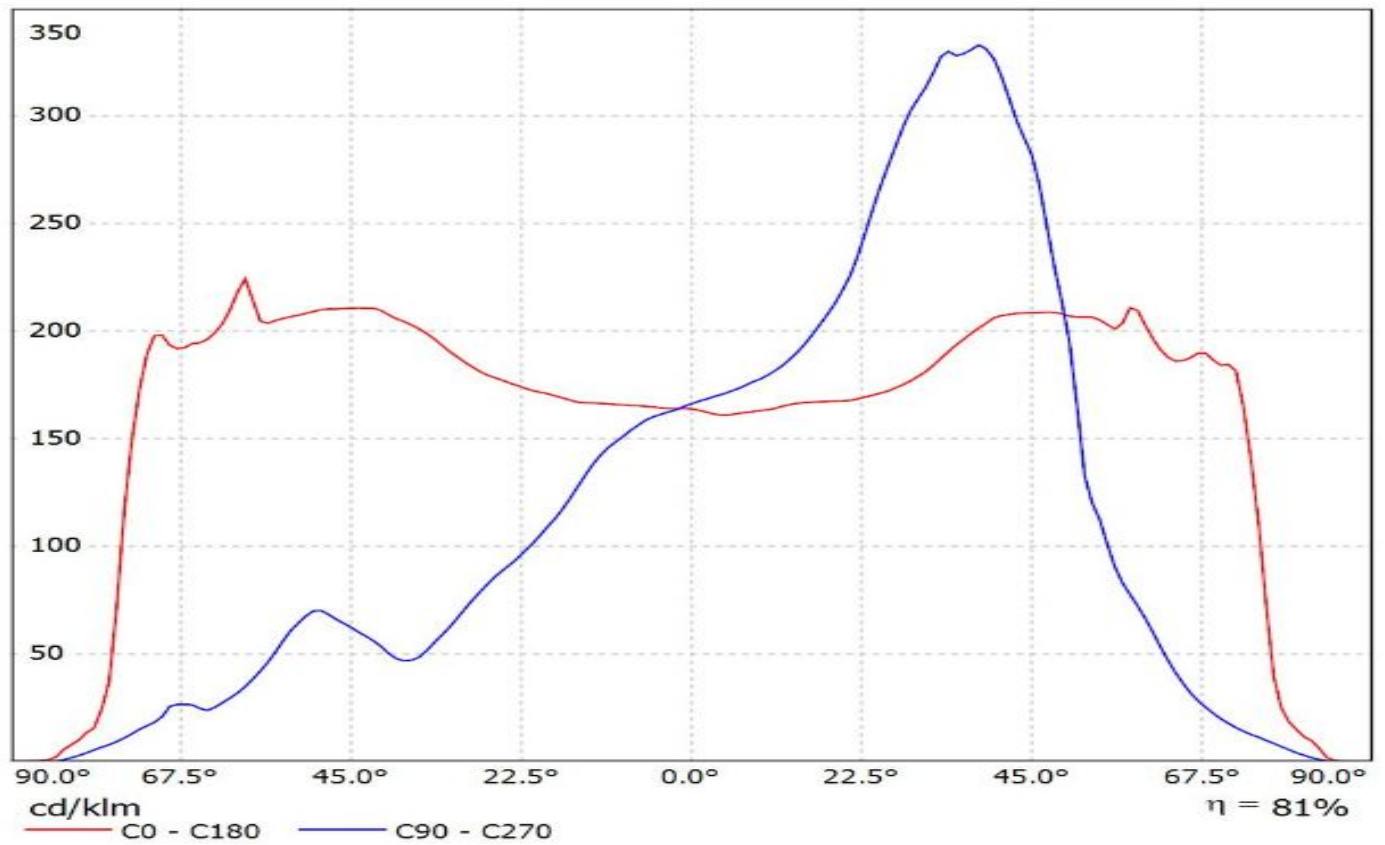

Luminaire: LEDiL Oy C14165_STRADA-2X2-ME-WIDE2_(Tridonic_Module_RLE_G1)
Lamps: 1 x Tridonic_Module_RLE_G1_4594.42lm@700mA_P=32.1515W_I=0.700A

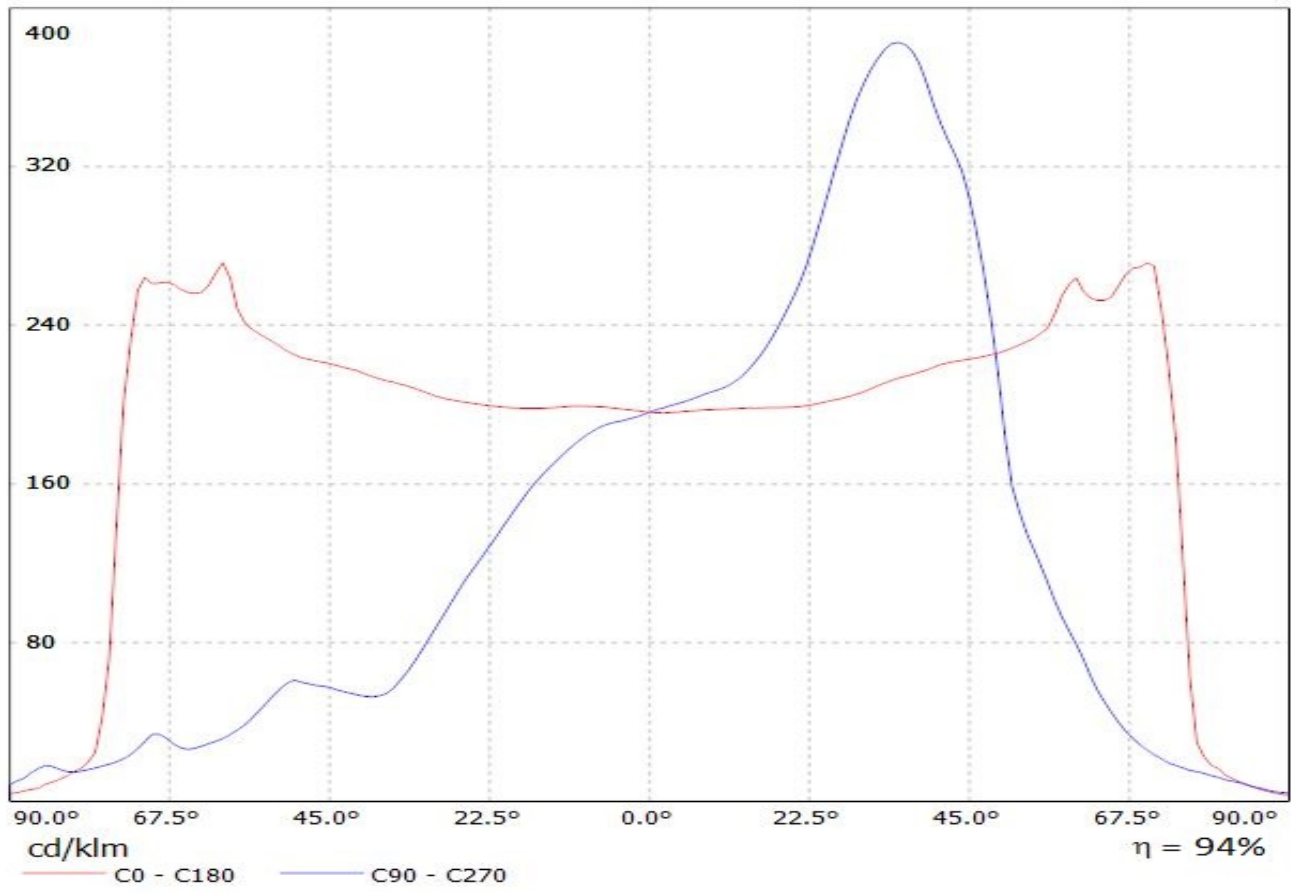

Luminaire: LEDiL Oy C14165_STRADA-2X2-ME-WIDE2_(Tridonic_Module_RLE_G1)
Lamps: 1 x Tridonic_Module_RLE_G1_4594.42lm@700mA_P=32.1515W_I=0.700A

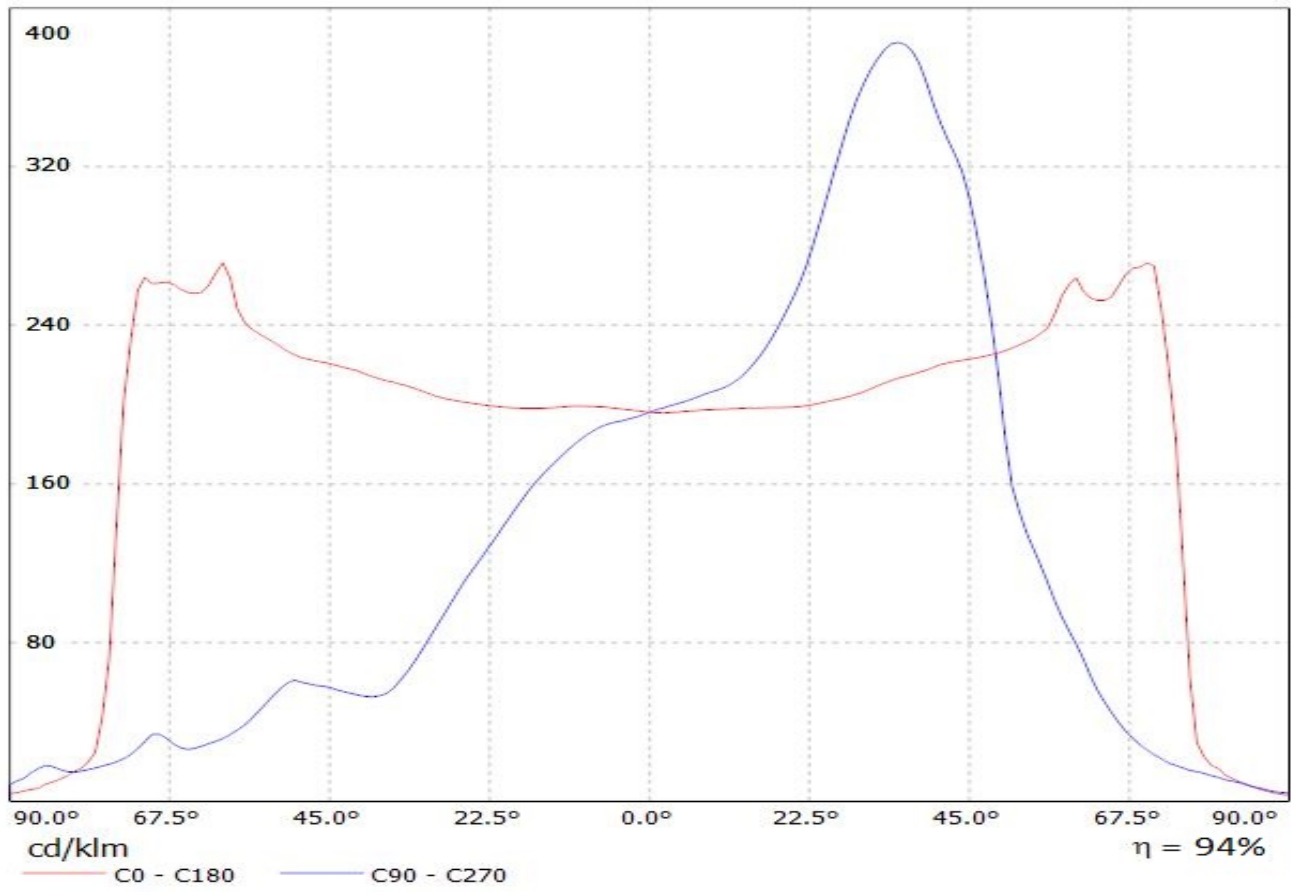

Luminaire: LEDiL Oy C14165_STRADA-2X2-ME-WIDE2_(Tridonic_Module_RLE_G1)
Lamps: 1 x Tridonic_Module_RLE_G1_2288lm@700mA_P=16W_I=0.700A

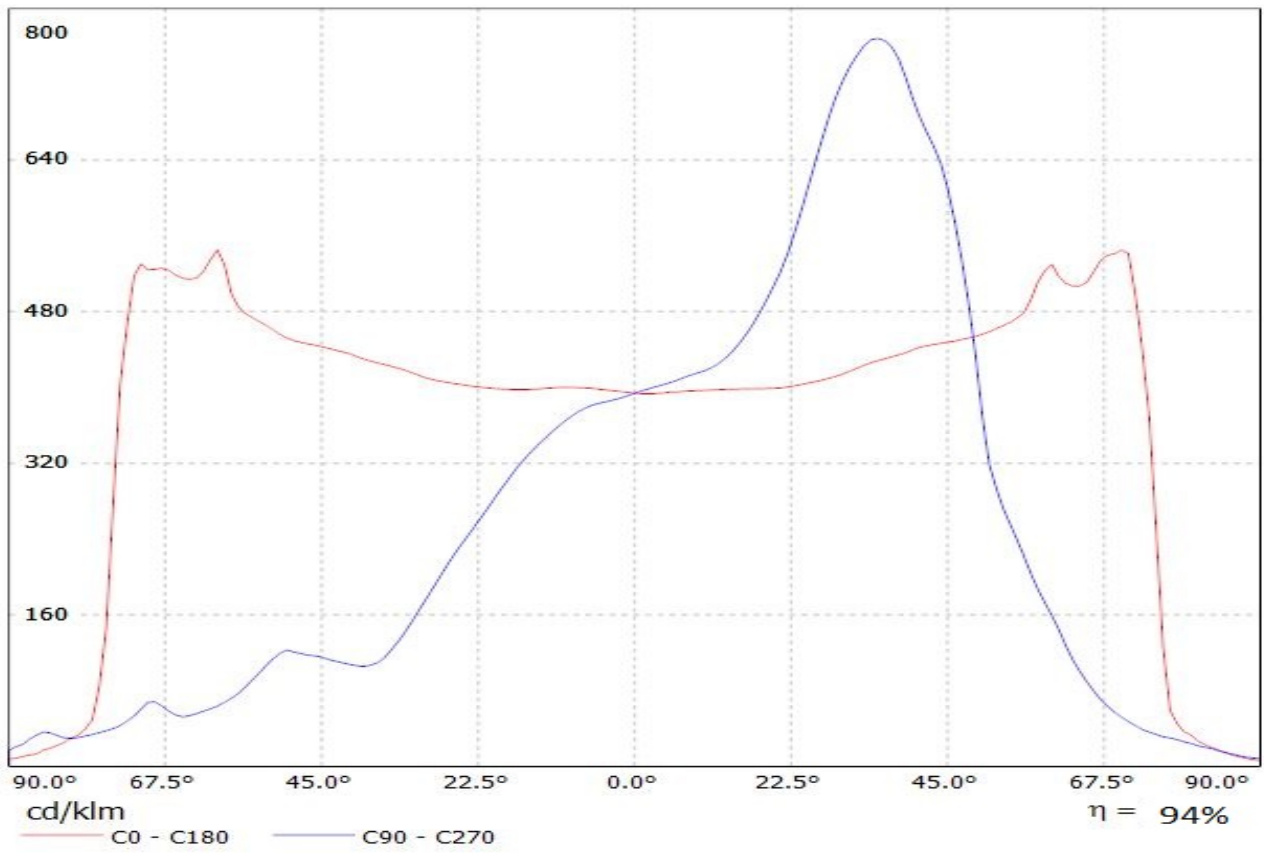

Luminaire: LEDiL Oy C14165_STRADA-2X2-ME-WIDE2_(Tridonic_Module_RLE_G1)
Lamps: 1 x Tridonic_Module_RLE_G1_2288lm@700mA_P=16W_I=0.700A

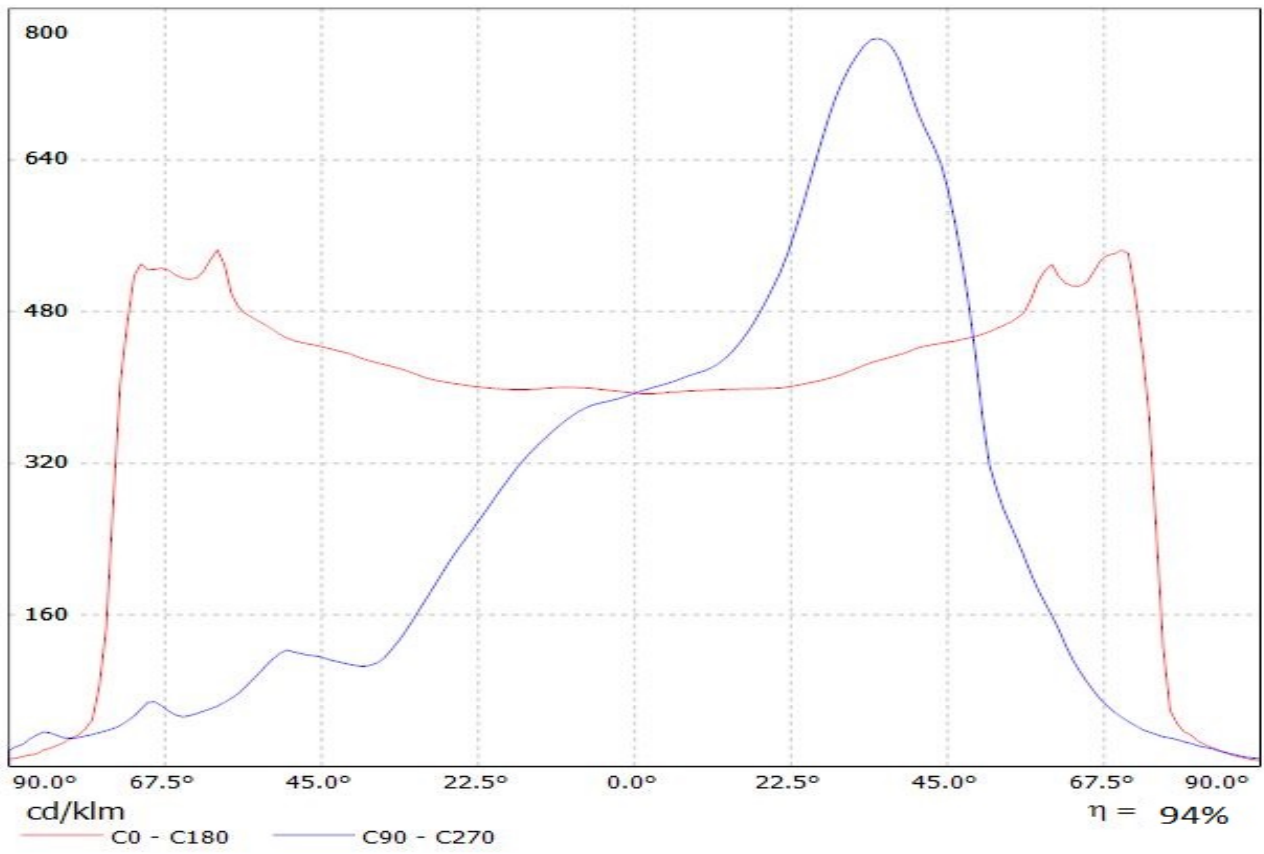

Luminaire: LEDiL Oy C14165_STRADA-2X2-ME-WIDE2_(XP-G2)
Lamps: 1 x CREE_XP-G2_2x2_(XPGBWT-L1-000-00G51)
_407.74lm@250mA_CCT=7181K_P=2.95432W_I=249.9mA

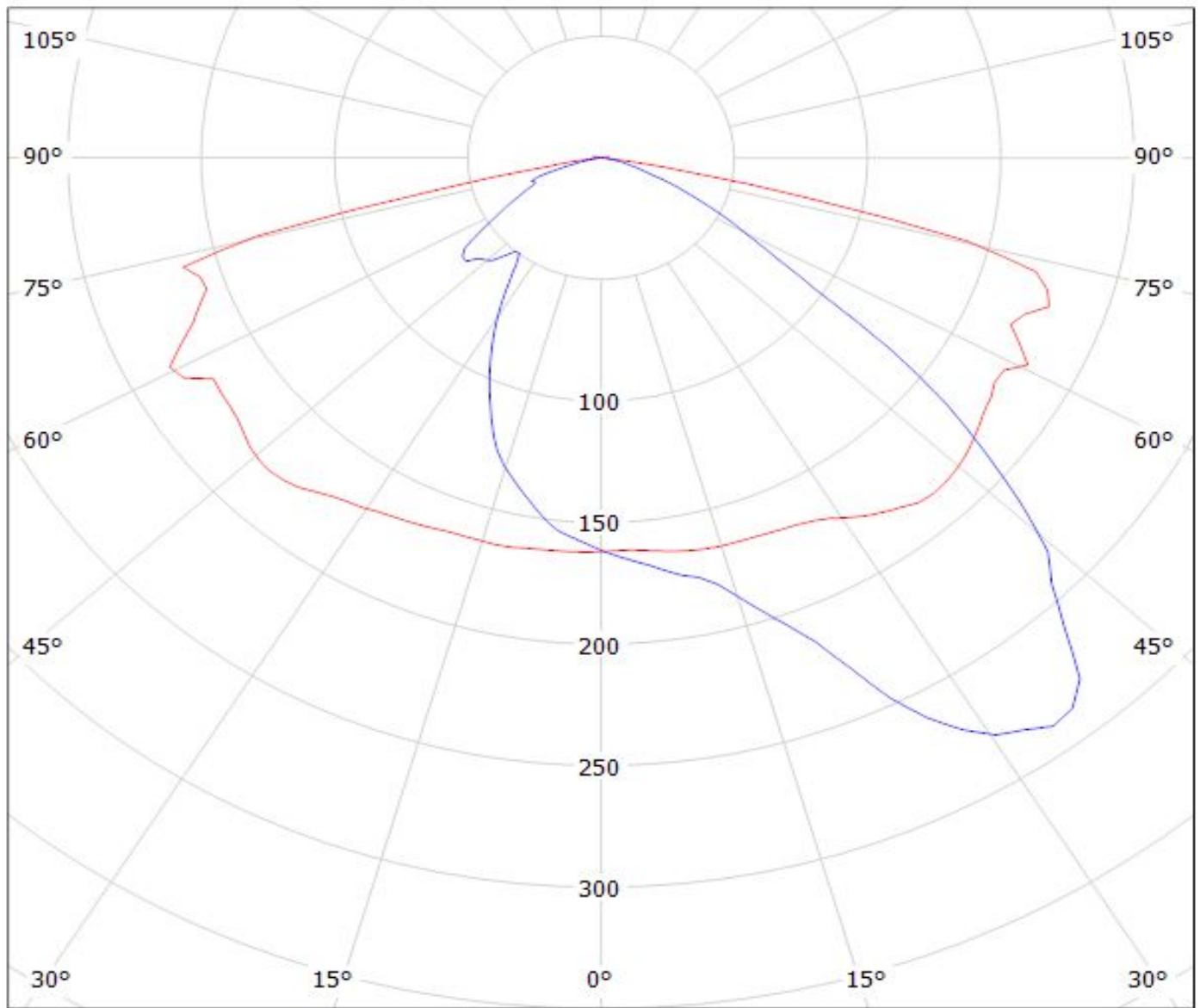

cd/klm

— C0 - C180 — C90 - C270

$\eta = 79\%$

Luminaire: Ledil Oy C14165_STRADA-2X2-ME-WIDE2_(XP-L)_SIMULATED
Lamps: 1 x Cree XP-L

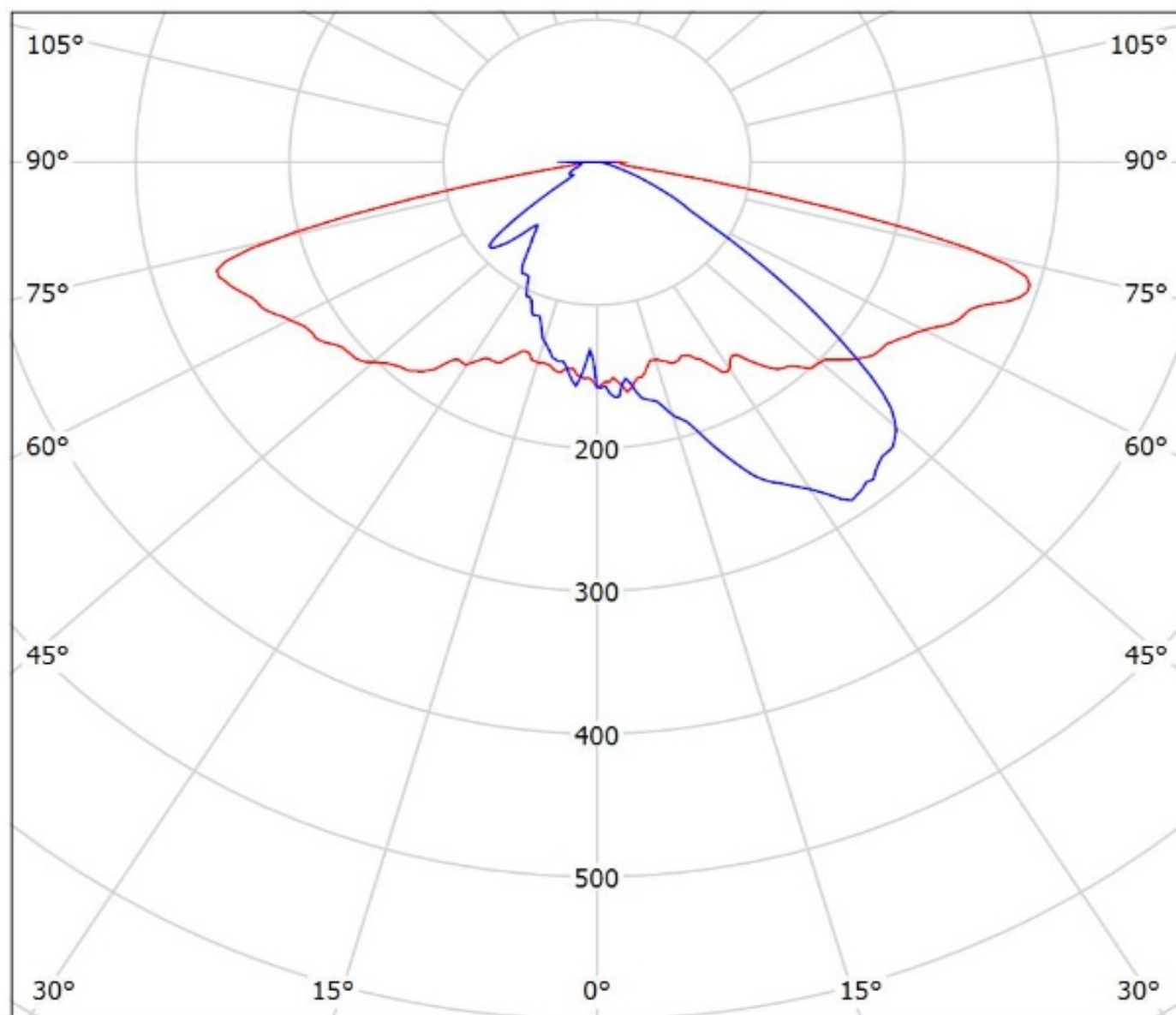

cd/klm
— C0 - C180 — C90 - C270

η = 90%

Luminaire: Ledil C14165_STRADA-2X2-ME-WIDE2_(XP-G3)_withglass

Lamps: 1 x Cree_XP-G3_2x2_(XPGDWT-B1-3C0-S4-0-01)_516.212lm@250mA_P=2.78875W_I=0.250A

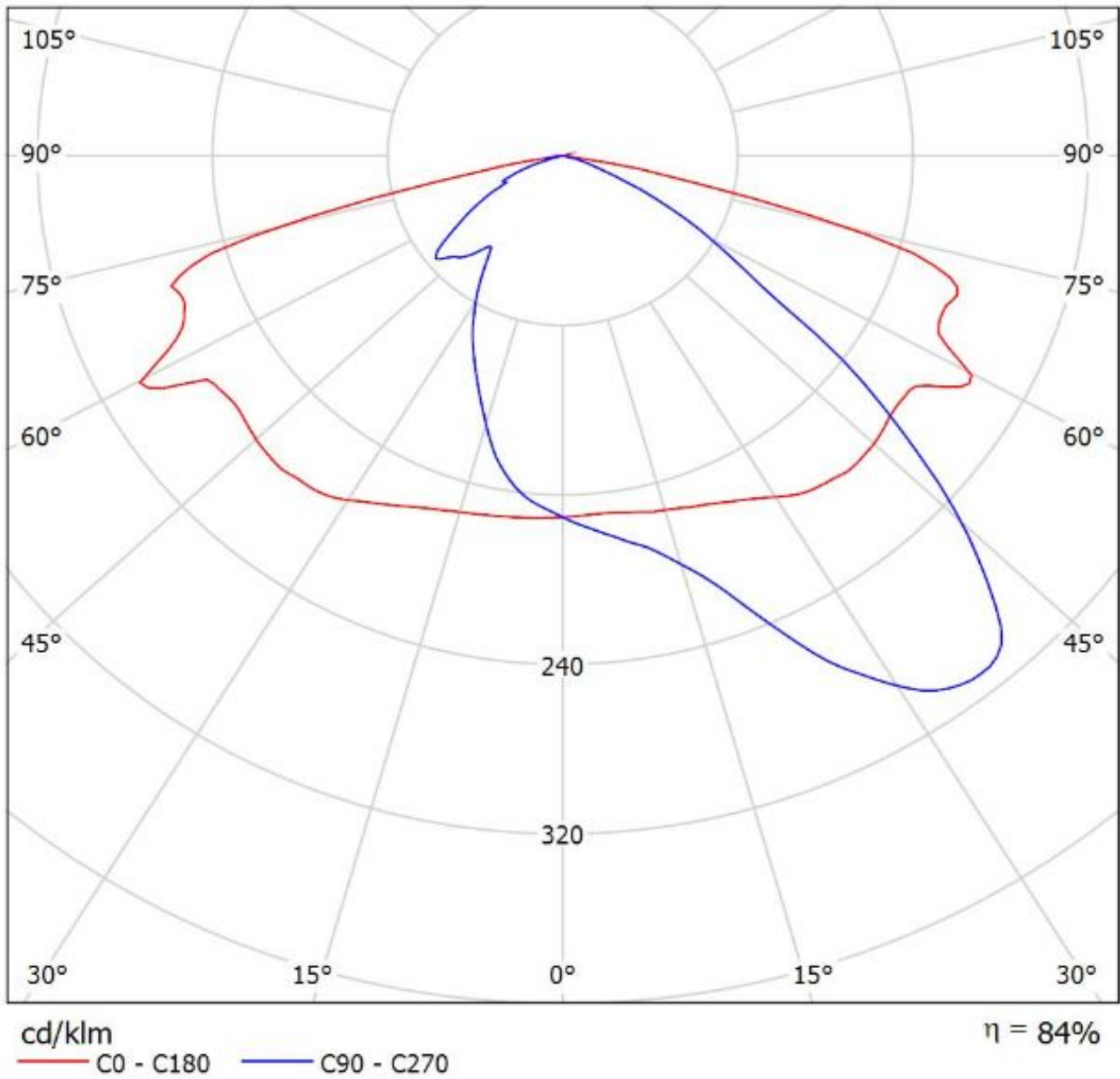

Luminaire: Ledil C14165_STRADA-2X2-ME-WIDE2_(XP-L2)

Lamps: 1 x Cree_XP-L2_2x2_(XPLBWT-00-0000-000BV50E3)550.93lm@250mA_P=2.7815W_η=0.25A

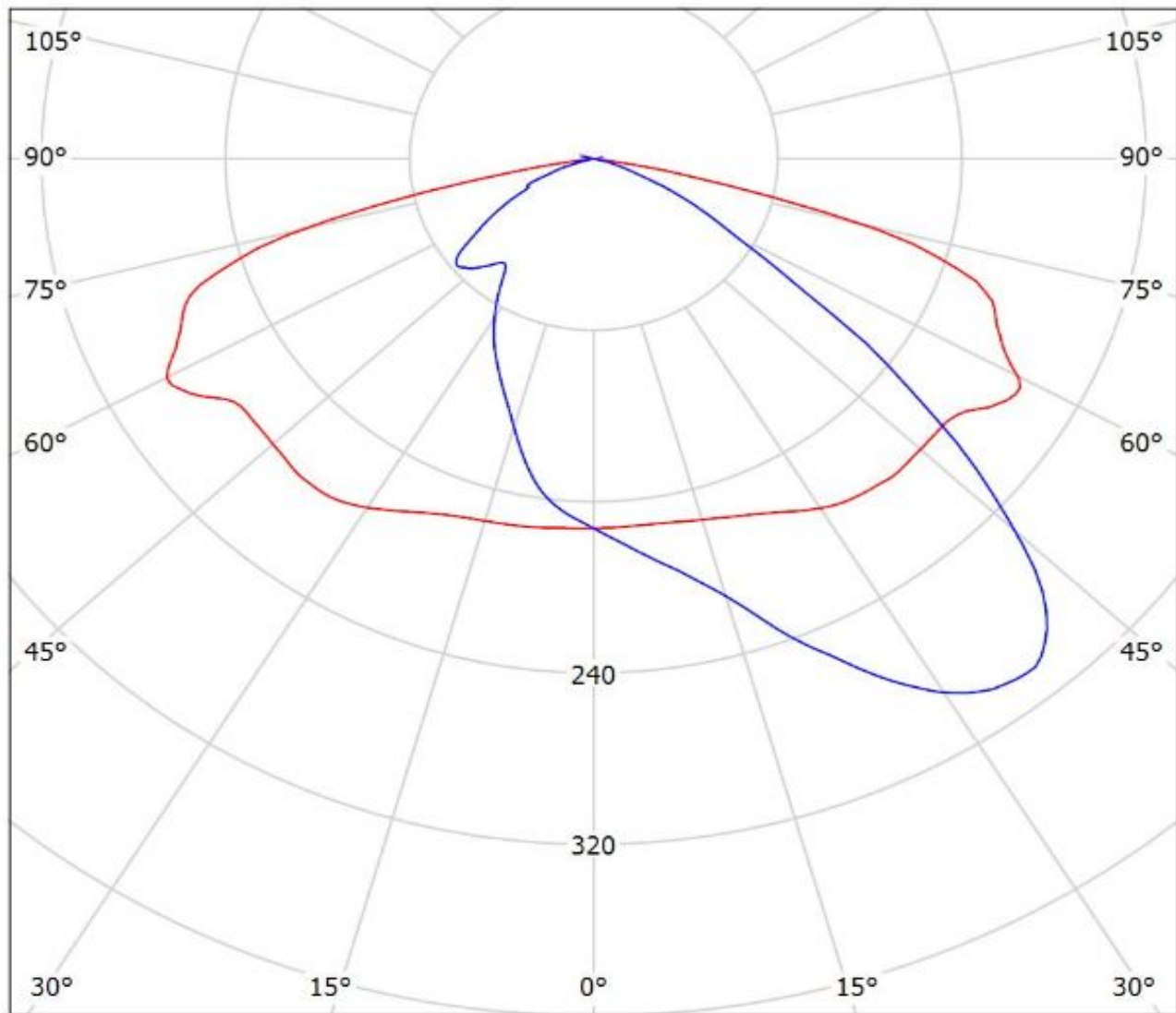

cd/klm

— C0 - C180

— C90 - C270

η = 83%

Luminaire: Ledil Oy C14165_STRADA-2X2-ME-WIDE2_(XHP35_HD)_SIMULATED
Lamps: 1 x Cree XHP35 HD

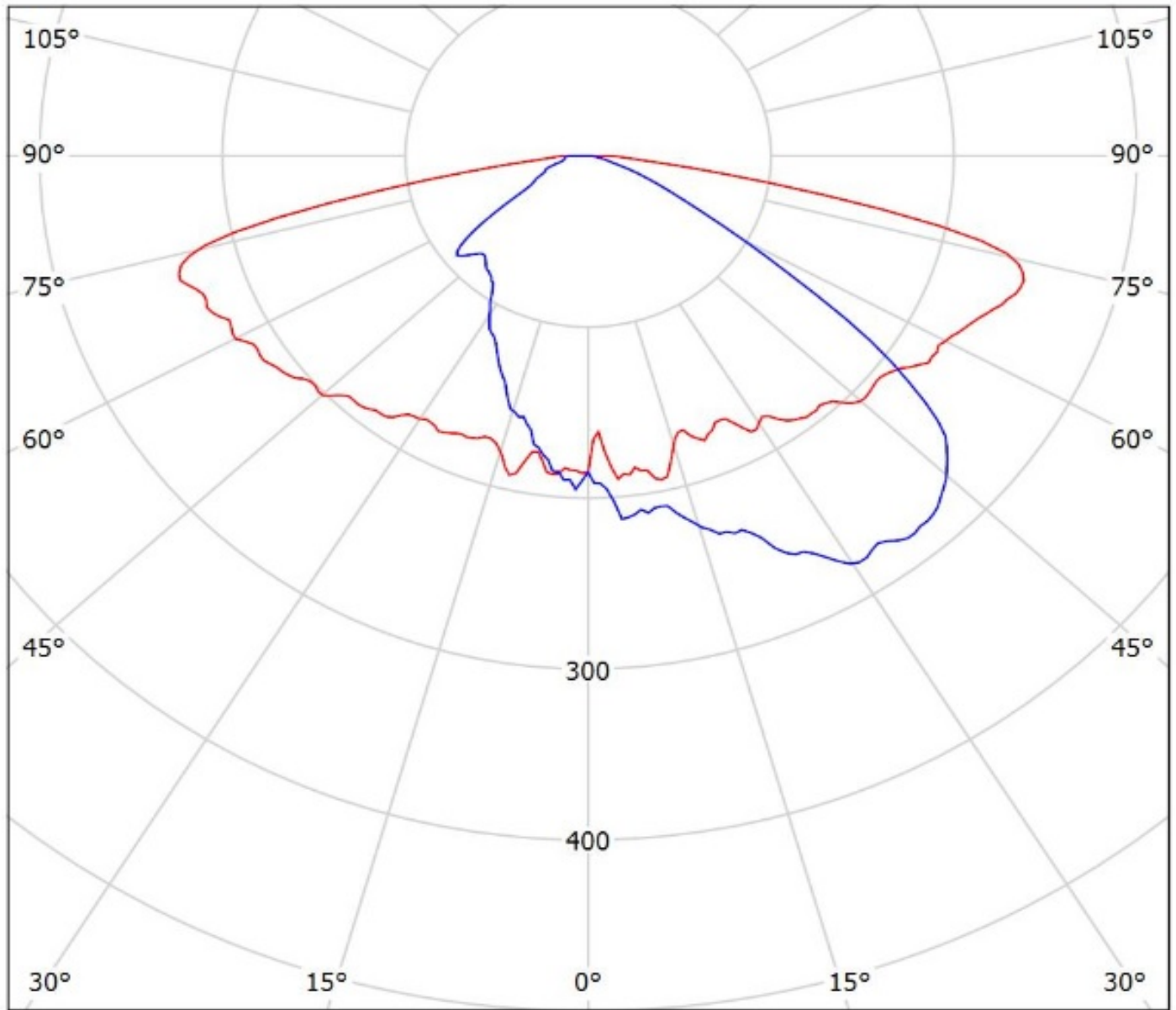

cd/klm

— C0 - C180 — C90 - C270

$\eta = 94\%$

Luminaire: Ledil C14165_STRADA-2X2-ME-WIDE2_(H35C1)_withglass
Lamps: 1 x LG_H35C1_2x2_477.216lm@250mA_P=2.87475W_I=0.250A

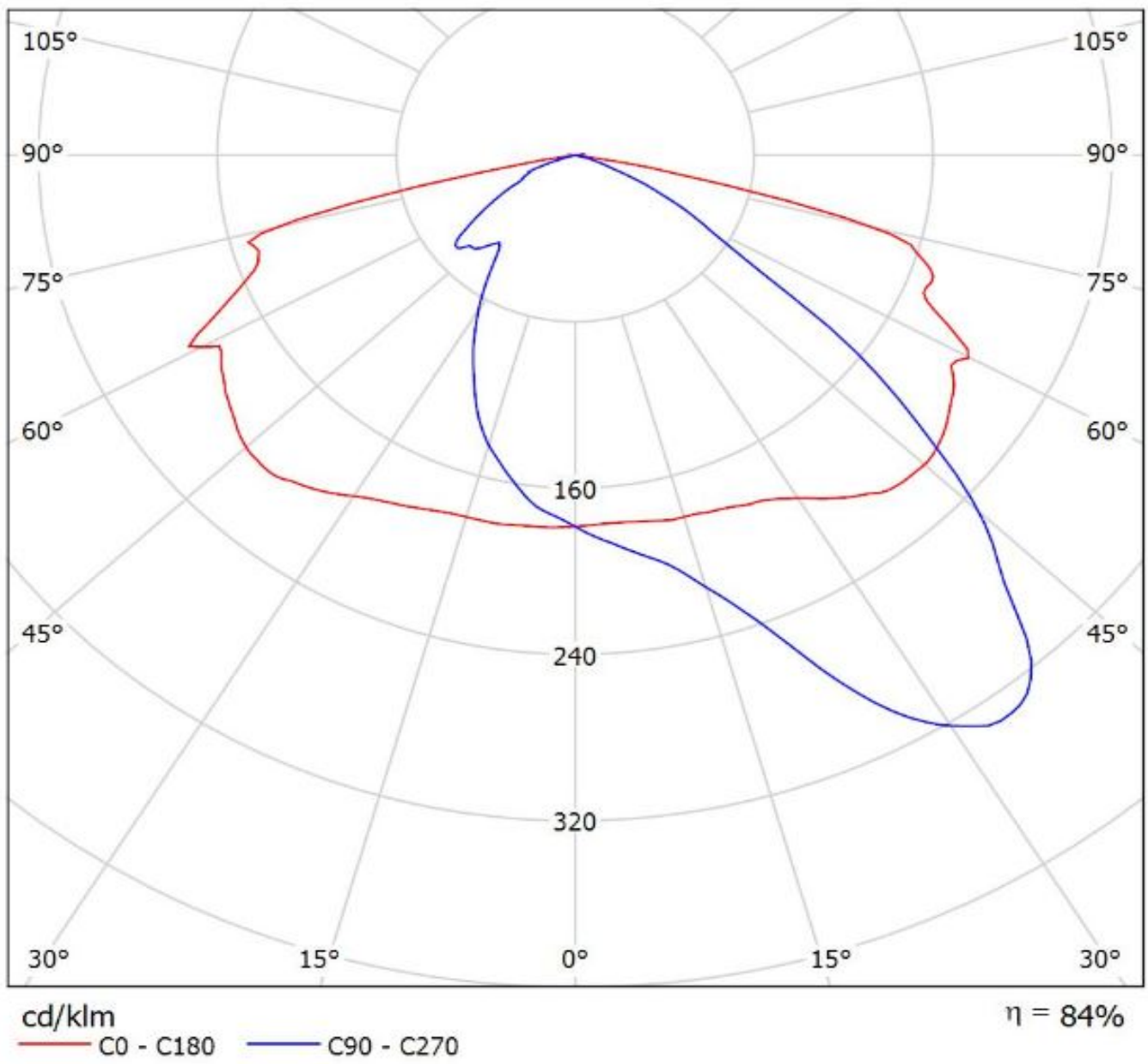

Luminaire: LEDiL Oy C14165_STRADA-2X2-ME-WIDE2_(NVSW319AE)
Lamps: 1 x Nichia_NVSW319AE_499.093lm@250mA_P=2.79052W_I=0.25A

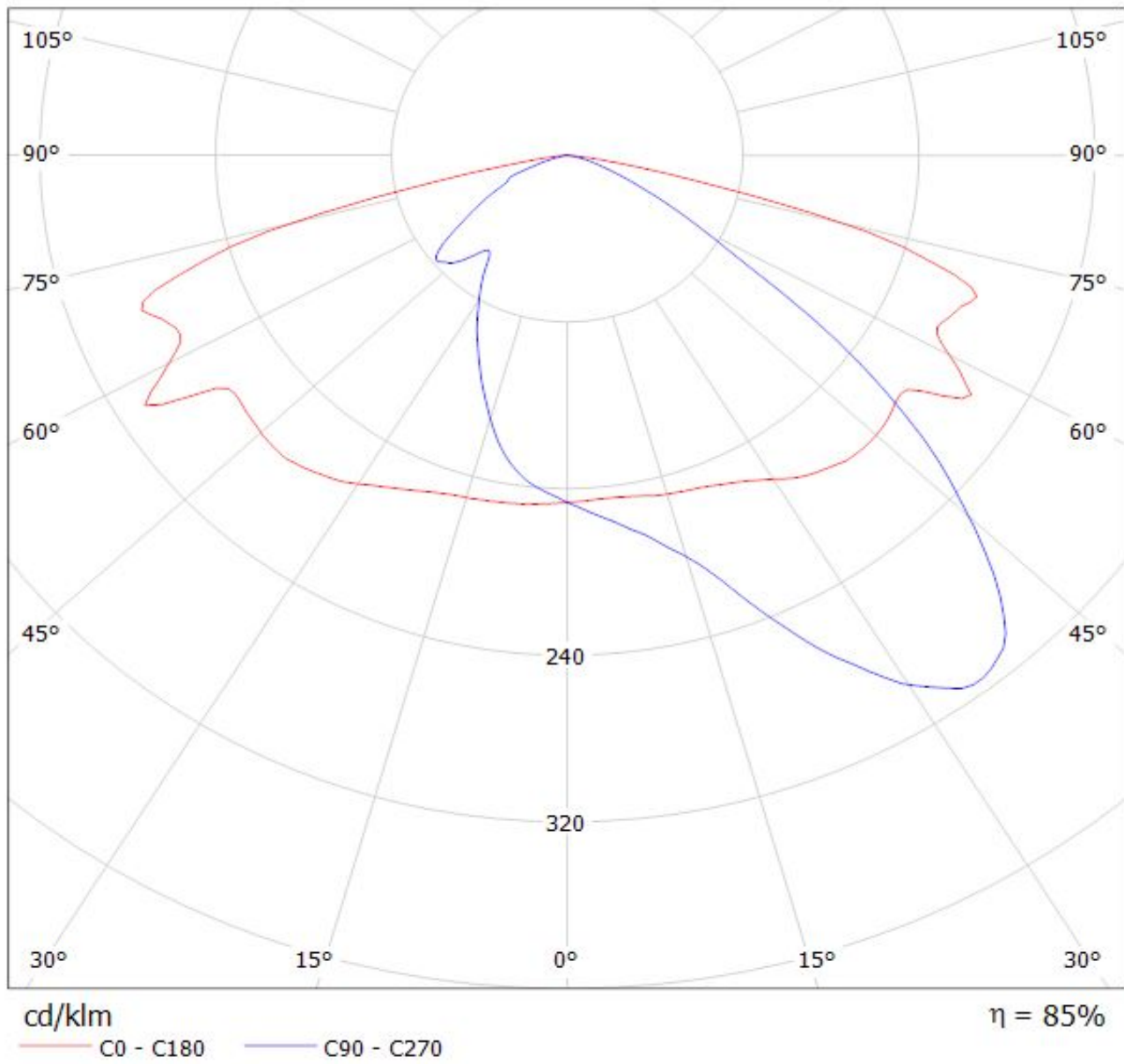

Luminaire: Ledil Oy C14165STRADA-2X2-ME-WIDE2_(Duris_S8_Gen2)_SIMULATED
Lamps: 1 x OSRAM_DURIS S8 GEN2 5050 package

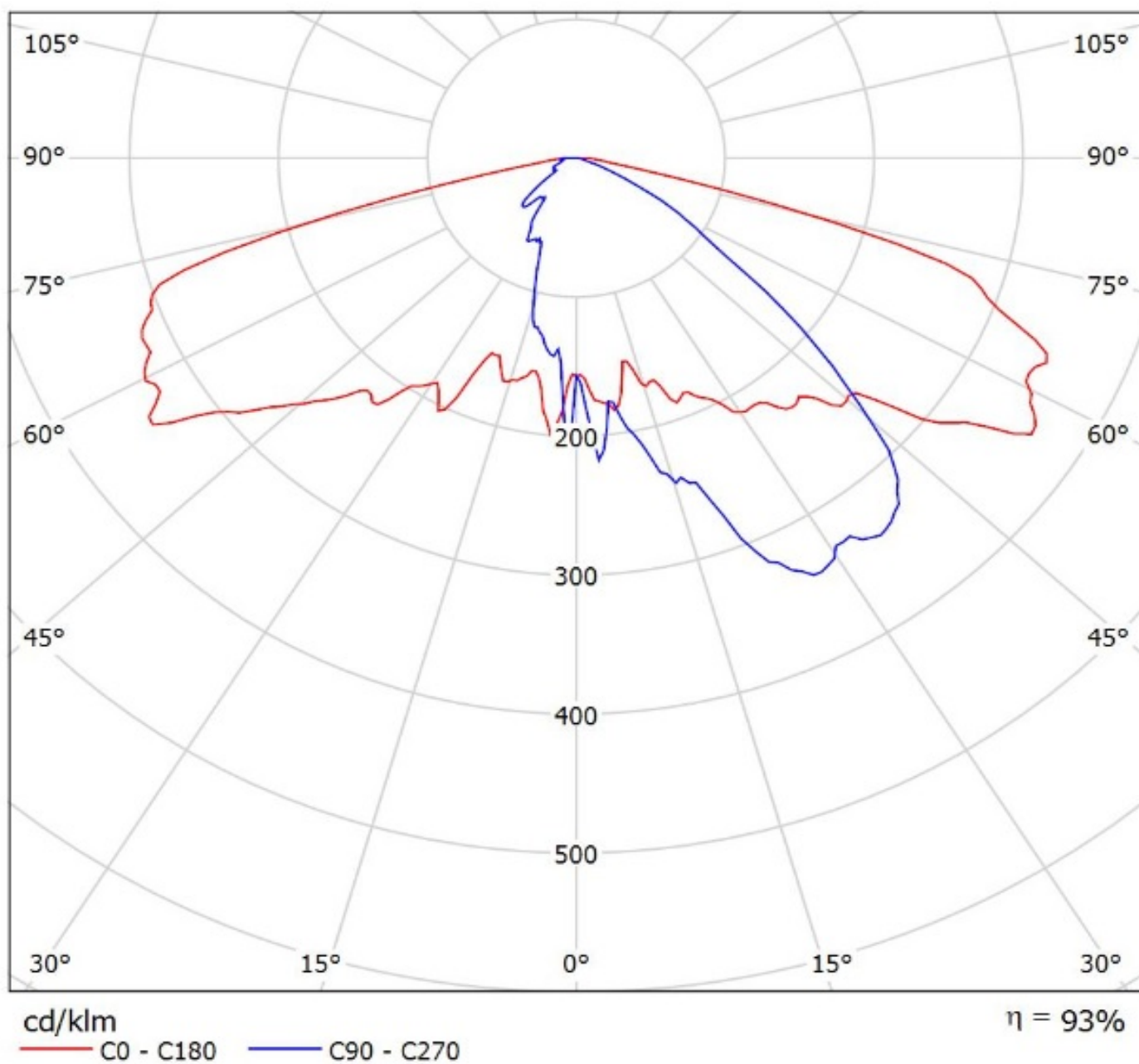

Luminaire: Ledil Oy C14165_STRADA-2X2-ME-WIDE2_(Oslon_Square_Gen3)_SIMULATED
Lamps: 1 x Osram Oslon Square Gen3 (GW CSSRM2.PC)

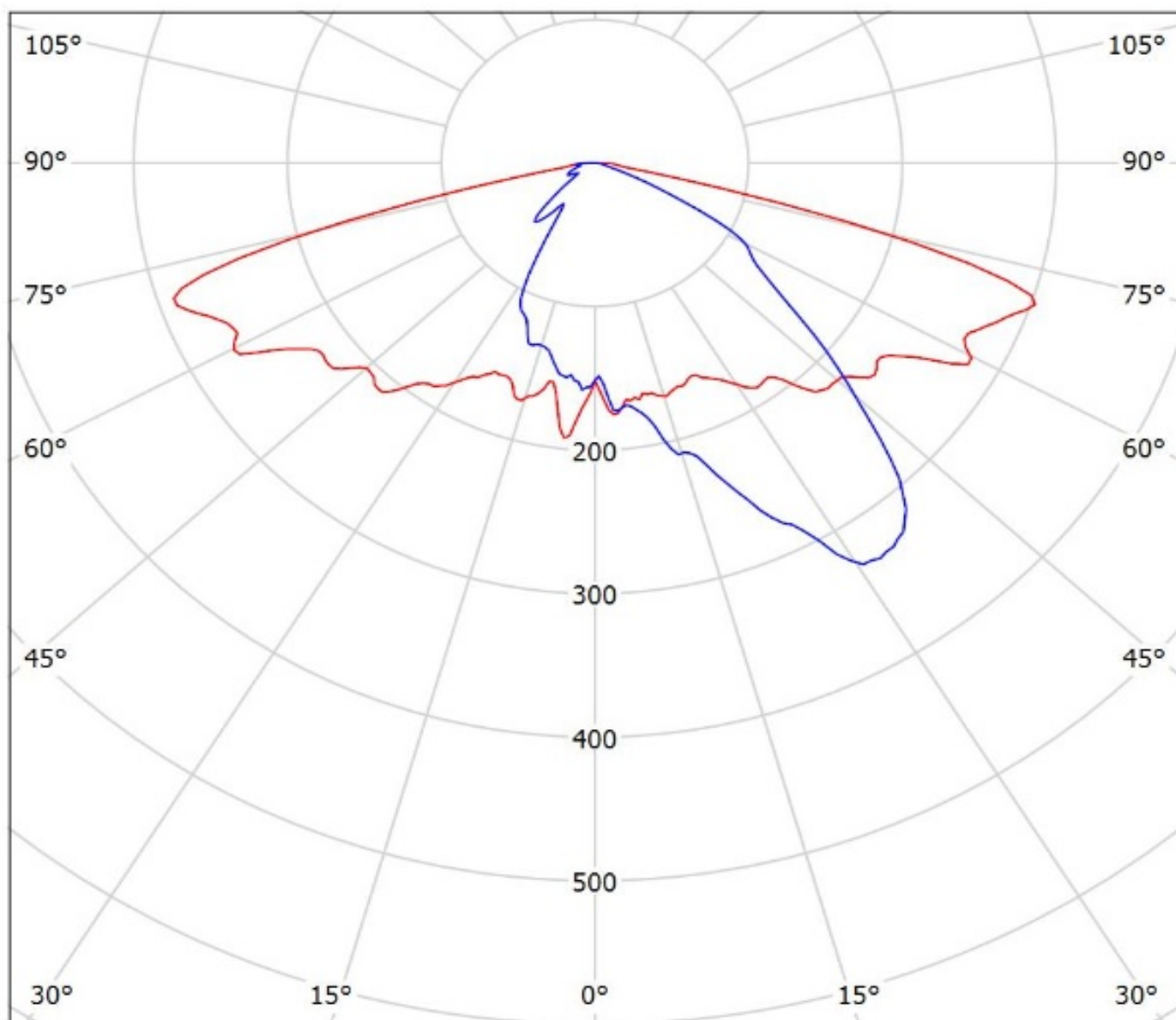

cd/klm
— C0 - C180 — C90 - C270

$\eta = 92\%$

Luminaire: LEDiL Oy C14165_STRADA-2X2-ME-WIDE2_(Fortimo_F-Flex_2x8_740DAG3)_glass

Lamps: 1 x Philips_Fortimo_FastFlex_LED_board_2x8_740_DA_G3_(Glass_chassis)_1774.78lm@250mA_P=11.5852W_I=0.2498A

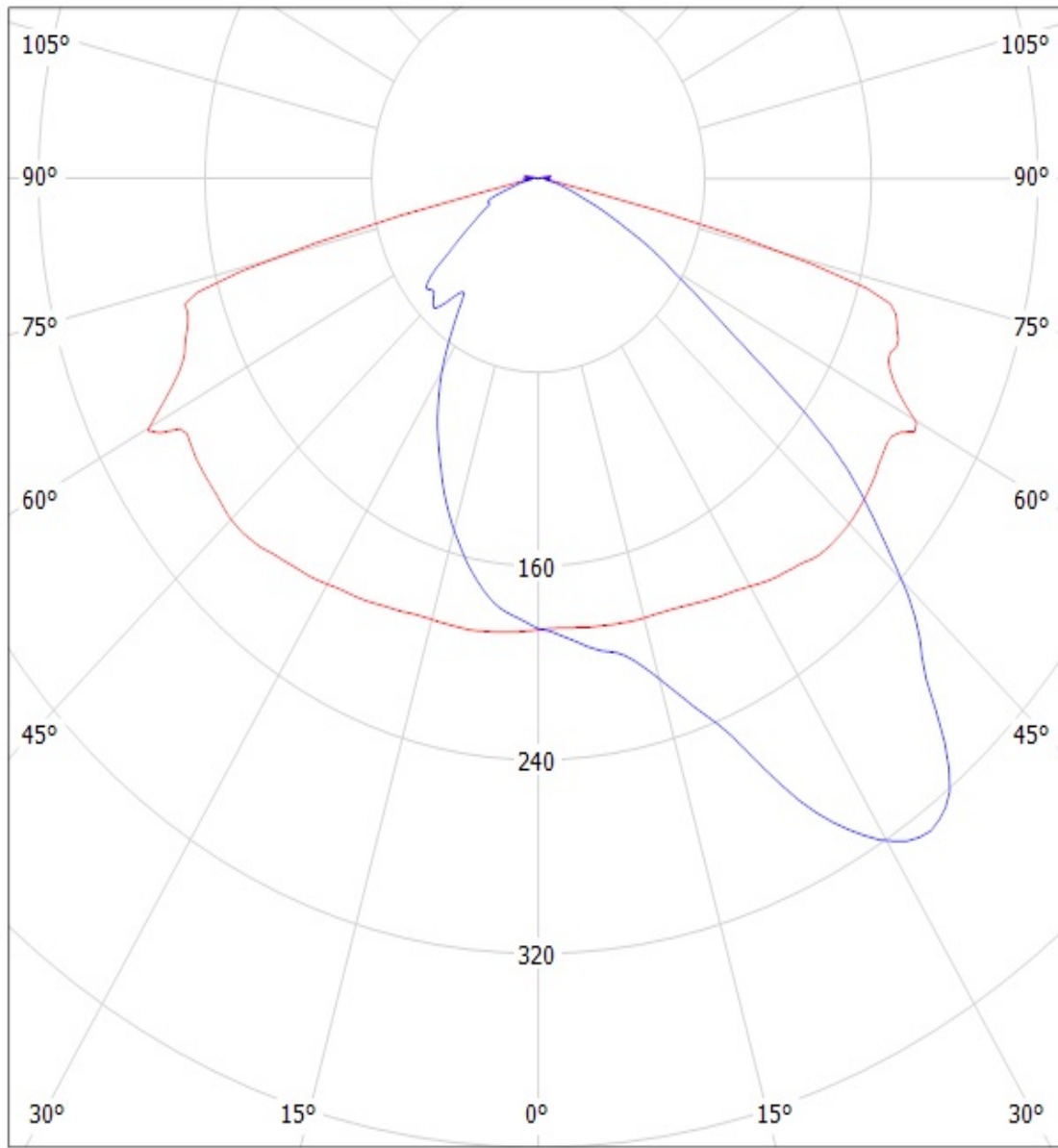

cd/klm

— C0 - C180

— C90 - C270

$\eta = 86\%$

Luminaire: Ledil C14165_STRADA-2X2-ME-WIDE2_(LH351B)

Lamps: 1 x Samsung_LH351B_2x2_442.633lm@250mA_P=2.851W_I=0.25A

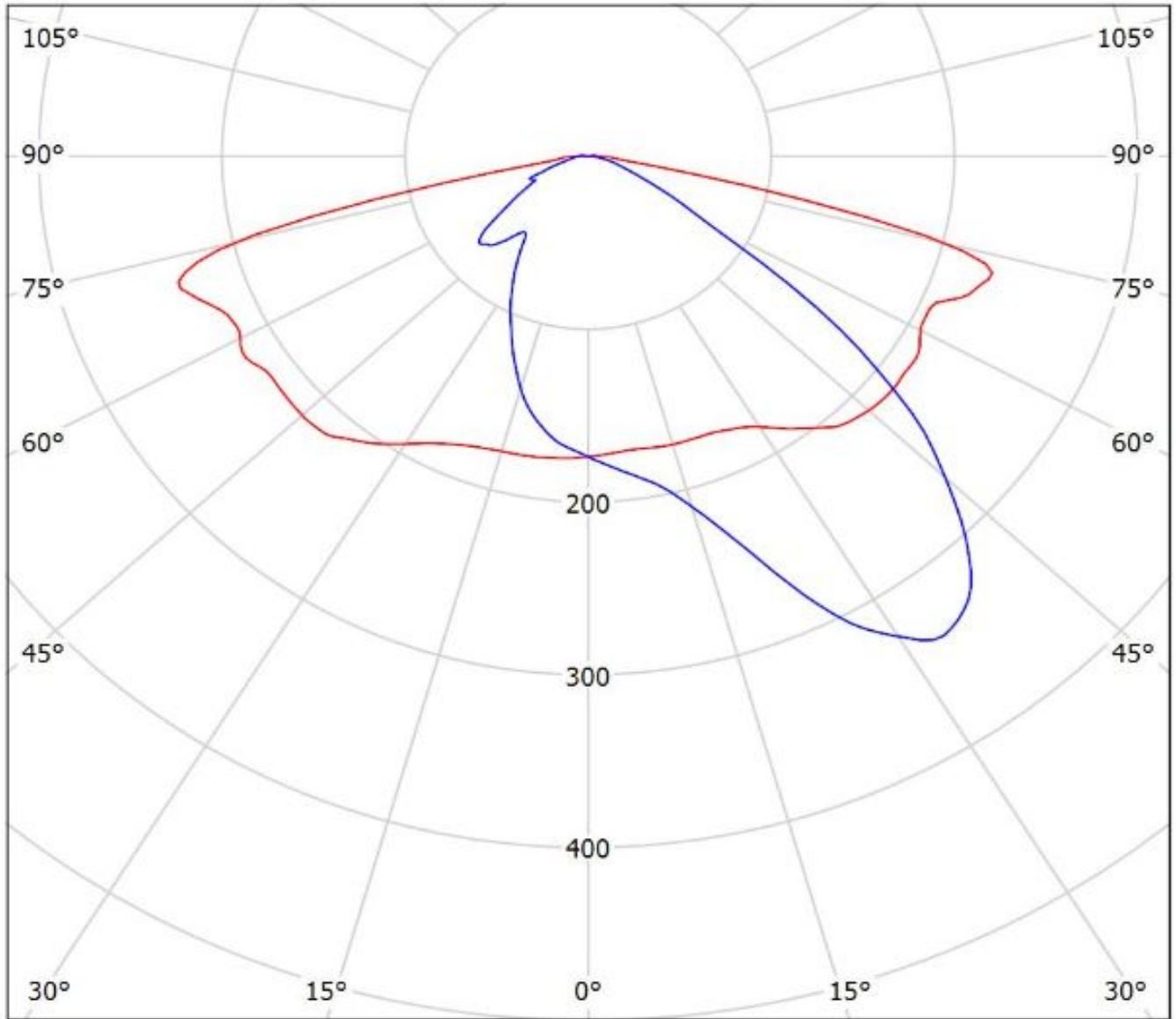

cd/klm

— C0 - C180

— C90 - C270

$\eta = 96\%$

Ledil C14165_STRADA-2X2-ME-WIDE2_(TL1L4)_glass / LDC (Polar)

Luminaire: Ledil C14165_STRADA-2X2-ME-WIDE2_(TL1L4)_glass

Lamps: 1 x Toshiba_TL1L4_2x2_(TL1L4-DW0)_444.089lm@250mA_CCT=6500K_P=2.9W_I=0.25A

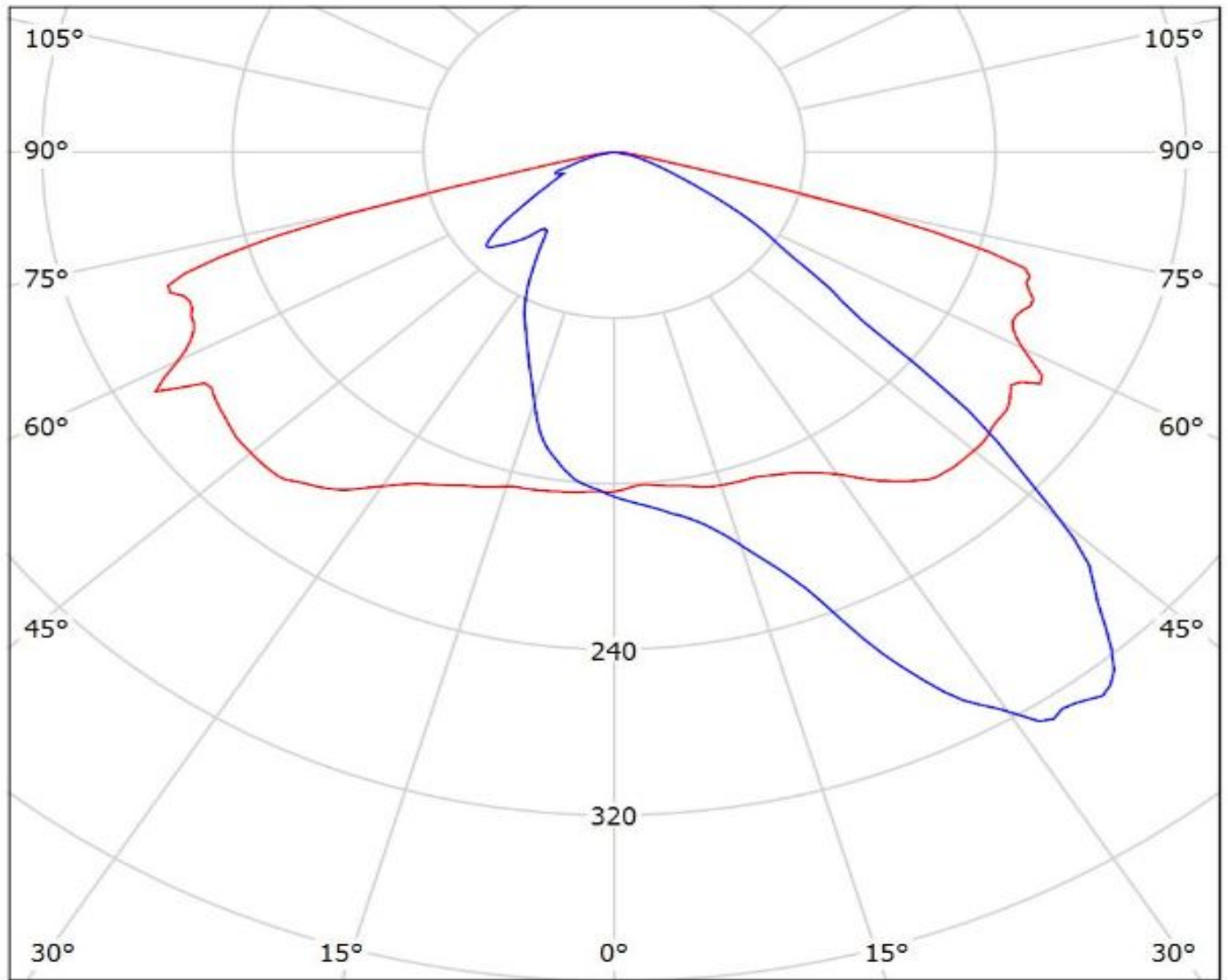

Luminaire: LEDiL Oy C14165_STRADA-2X2-ME-WIDE2_(Tridonic_Module_RLE_G1)
Lamps: 1 x Tridonic_Module_RLE_G1_4594.42lm@700mA_P=32.1515W_I=0.700A

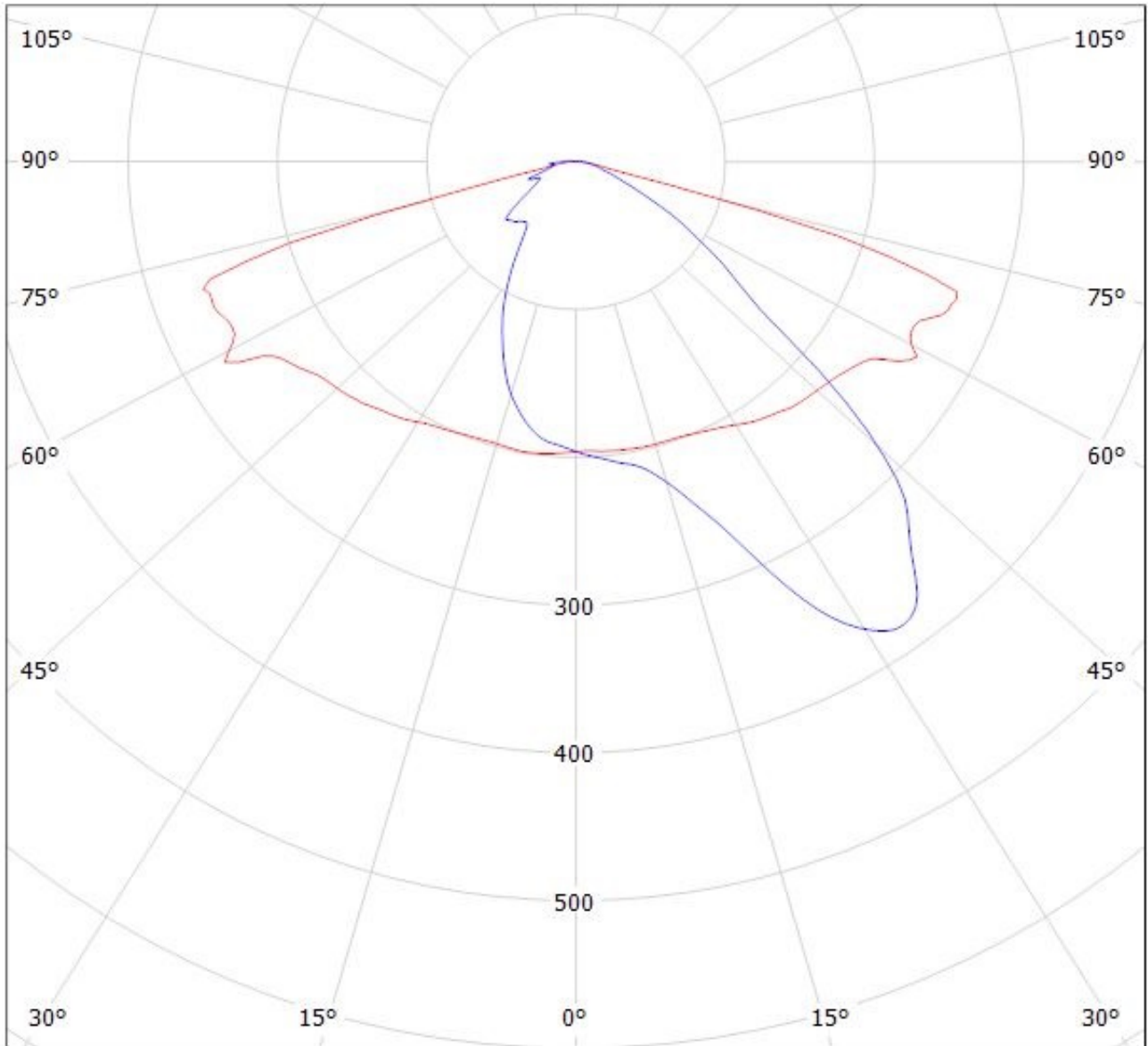

cd/klm

$\eta = 94\%$

— C0 - C180 — C90 - C270

Luminaire: LEDiL Oy C14165_STRADA-2X2-ME-WIDE2_(Tridonic_Module_RLE_G1)
Lamps: 1 x Tridonic_Module_RLE_G1_4594.42lm@700mA_P=32.1515W_I=0.700A

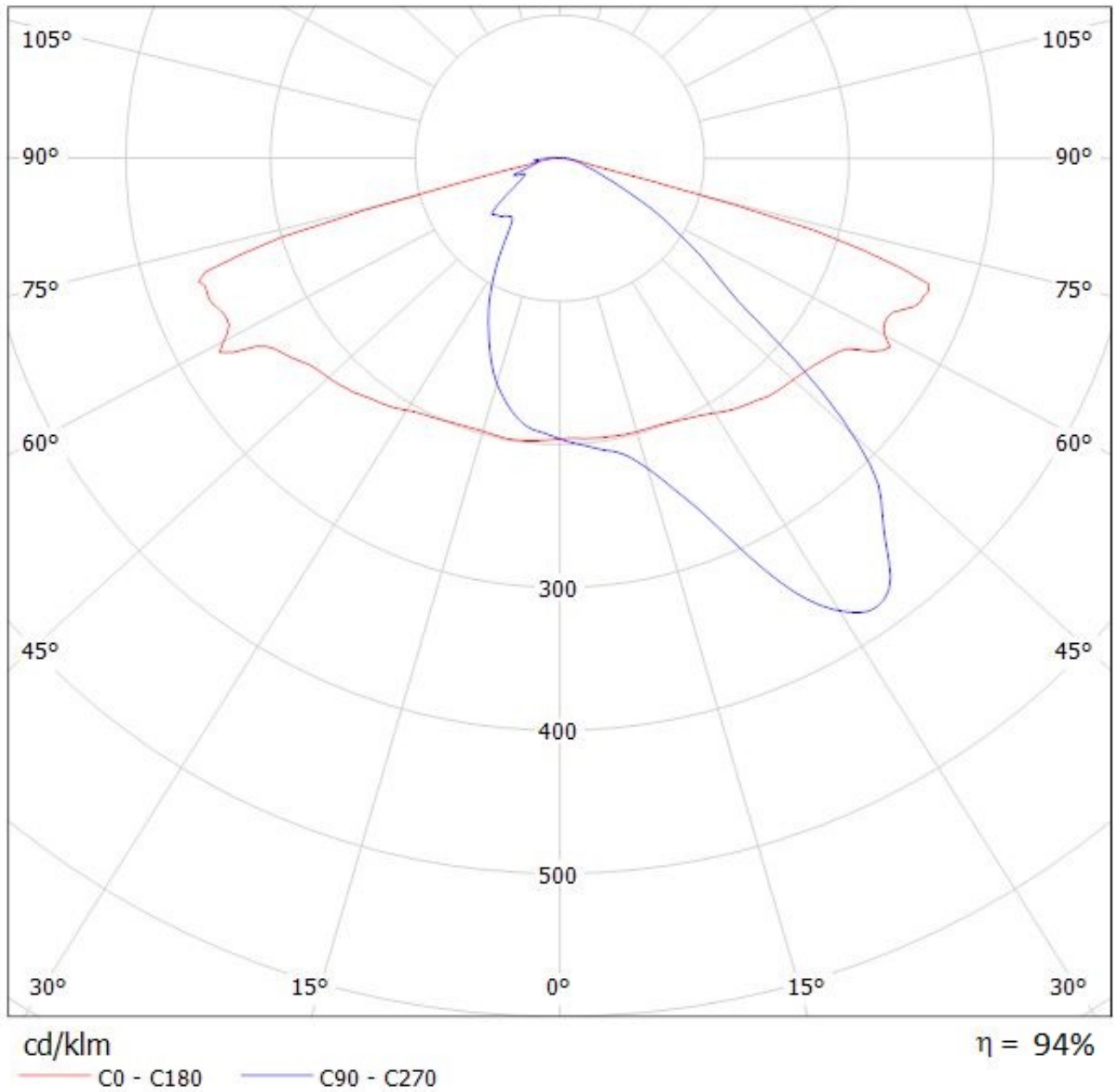

Luminaire: LEDiL Oy C14165_STRADA-2X2-ME-WIDE2_(Tridonic_Module_RLE_G1)

Lamps: 1 x Tridonic_Module_RLE_G1_2288lm@700mA_P=16W_η=0.700A

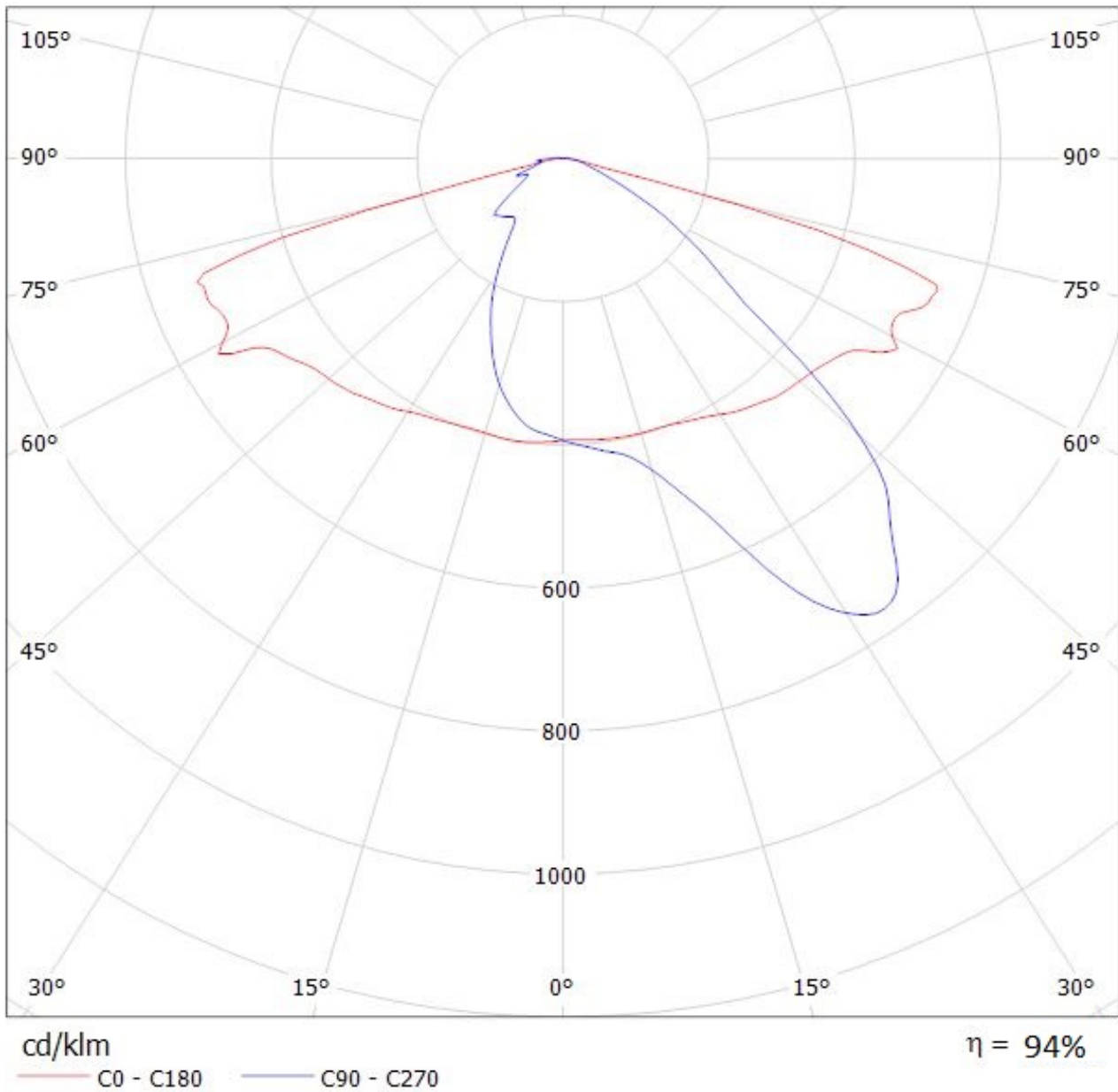

Luminaire: LEDiL Oy C14165_STRADA-2X2-ME-WIDE2_(Tridonic_Module_RLE_G1)

Lamps: 1 x Tridonic_Module_RLE_G1_2288lm@700mA_P=16W_η=0.700A

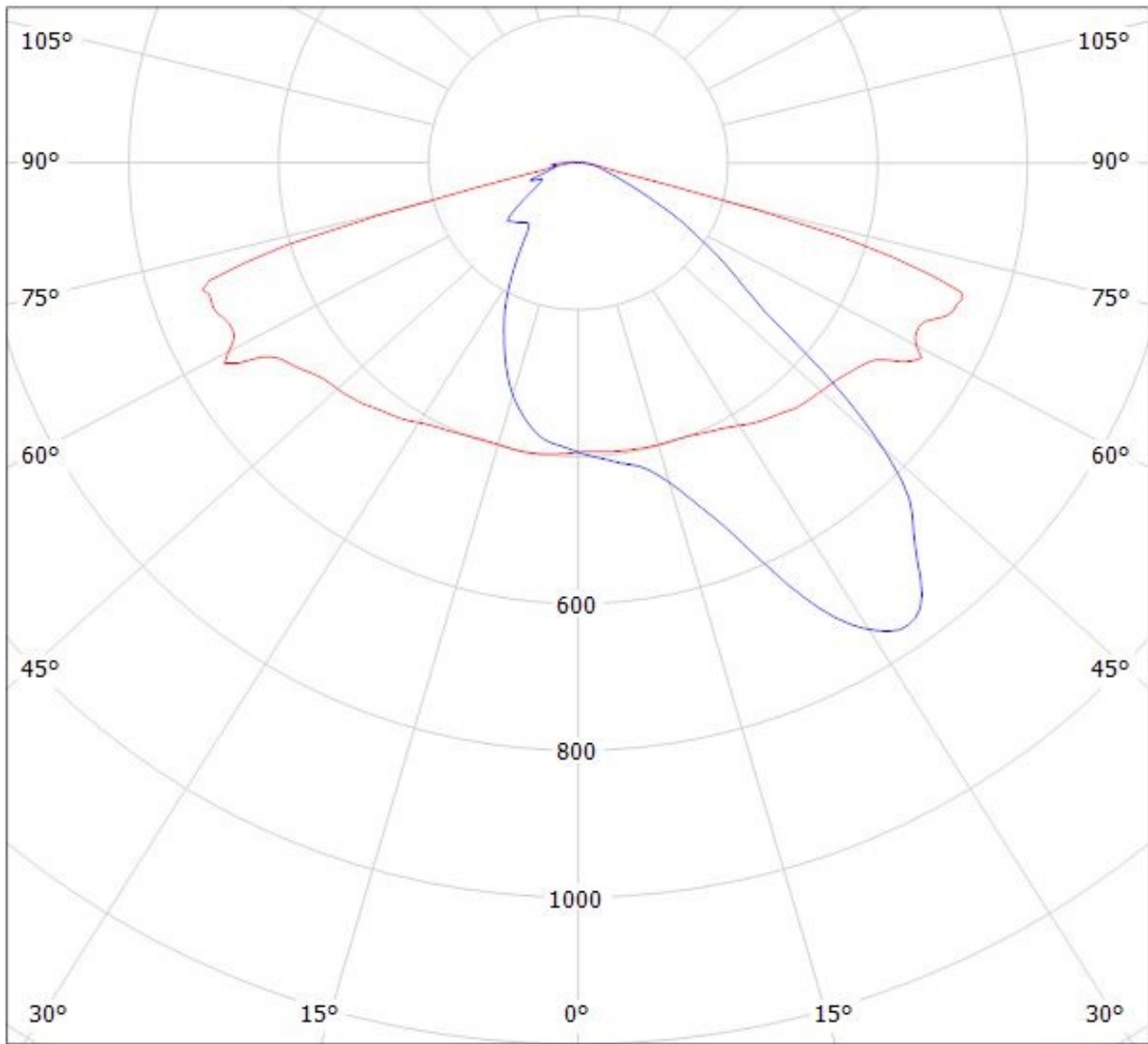

cd/klm

— C0 - C180

— C90 - C270

η = 94%

NOTE: The typical divergence will be changed by different color, chip size and chip position tolerance. The typical total divergence is the full angle measured where the luminous intensity is half of the peak value.