

# PRODUCT DATASHEET

## Mira series

last update 26/6/2015

**Product number C12500\_MIRA-M**

Family	Mira	FWHM	28 degrees
Type	Lens	Efficiency	83 %
LED	MT-G	cd/lm	2.200
Color	Clear	Gerber File	Available
Diameter	32.4 mm		
Height	14.7 mm		
Style	Round		
Optic Material	PC		
Holder Material	-		
Fastening	-		
Status	Production ready		

**Product number CA12503\_MIRA-M**

Family	Mira	FWHM	28 degrees
Type	Assembly	Efficiency	83 %
LED	MT-G	cd/lm	-
Color	White	Gerber File	Available
Diameter	35 mm		
Height	15.8 mm		
Style	Round		
Optic Material	PC		
Holder Material	-		
Fastening	["tape"]		
Status	Production ready		

**Product number C12501\_MIRA-W**

Family	Mira	FWHM	38 degrees
Type	Lens	Efficiency	80 %
LED	MT-G	cd/lm	1.400
Color	Clear	Gerber File	Available
Diameter	32.4 mm		
Height	14.7 mm		
Style	Round		
Optic Material	PC		
Holder Material	-		
Fastening	-		
Status	Production ready		

**Product number CA12504\_MIRA-W**

Family	Mira	FWHM	44 degrees
Type	Assembly	Efficiency	82 %
LED	MT-G	cd/lm	-
Color	White	Gerber File	Available
Diameter	35 mm		
Height	15.8 mm		
Style	Round		
Optic Material	PC		
Holder Material	-		
Fastening	["tape"]		
Status	Production ready		

# PRODUCT DATASHEET

## Mira series

last update 26/6/2015

**Product number C12502\_MIRA-WW**

Family	Mira	FWHM	58 degrees
Type	Lens	Efficiency	81 %
LED	MT-G	cd/lm	0.900
Color	Clear	Gerber File	Available
Diameter	32.4 mm		
Height	14.7 mm		
Style	Round		
Optic Material	PC		
Holder Material	-		
Fastening	["glue"]		
Status	Production ready		

**Product number CA12505\_MIRA-WW**

Family	Mira	FWHM	66 degrees
Type	Assembly	Efficiency	81 %
LED	MT-G	cd/lm	-
Color	White	Gerber File	Available
Diameter	35 mm		
Height	15.8 mm		
Style	Round		
Optic Material	PC		
Holder Material	-		
Fastening	["tape"]		
Status	Production ready		

**NOTE: The typical divergence will be changed by different color, chip size and chip position tolerance. The typical total divergence is the full angle measured where the luminous intensity is half of the peak value.**



## PRODUCT DATASHEET

### Mira series

last update 26/6/2015

#### GENERAL INFORMATION

- Product series especially designed & optimized for MT-G series of LEDs.
- Special care taken to make light distribution as uniform as possible.
- Lens material optical grade PC with high UV and temperature resistance (100 degrees of Celcius / 212 degrees of Fahrenheit). Allows use of high current and temperature conditions.

Please find more information about used materials from below:

[http://ledil.fi/sites/default/files/Documents/Technical/Material/PC%20Makrolon%202400\\_2407\\_2456\\_2458-UL.pdf](http://ledil.fi/sites/default/files/Documents/Technical/Material/PC%20Makrolon%202400_2407_2456_2458-UL.pdf)

Relative intensity of C12501\_MIRA-W

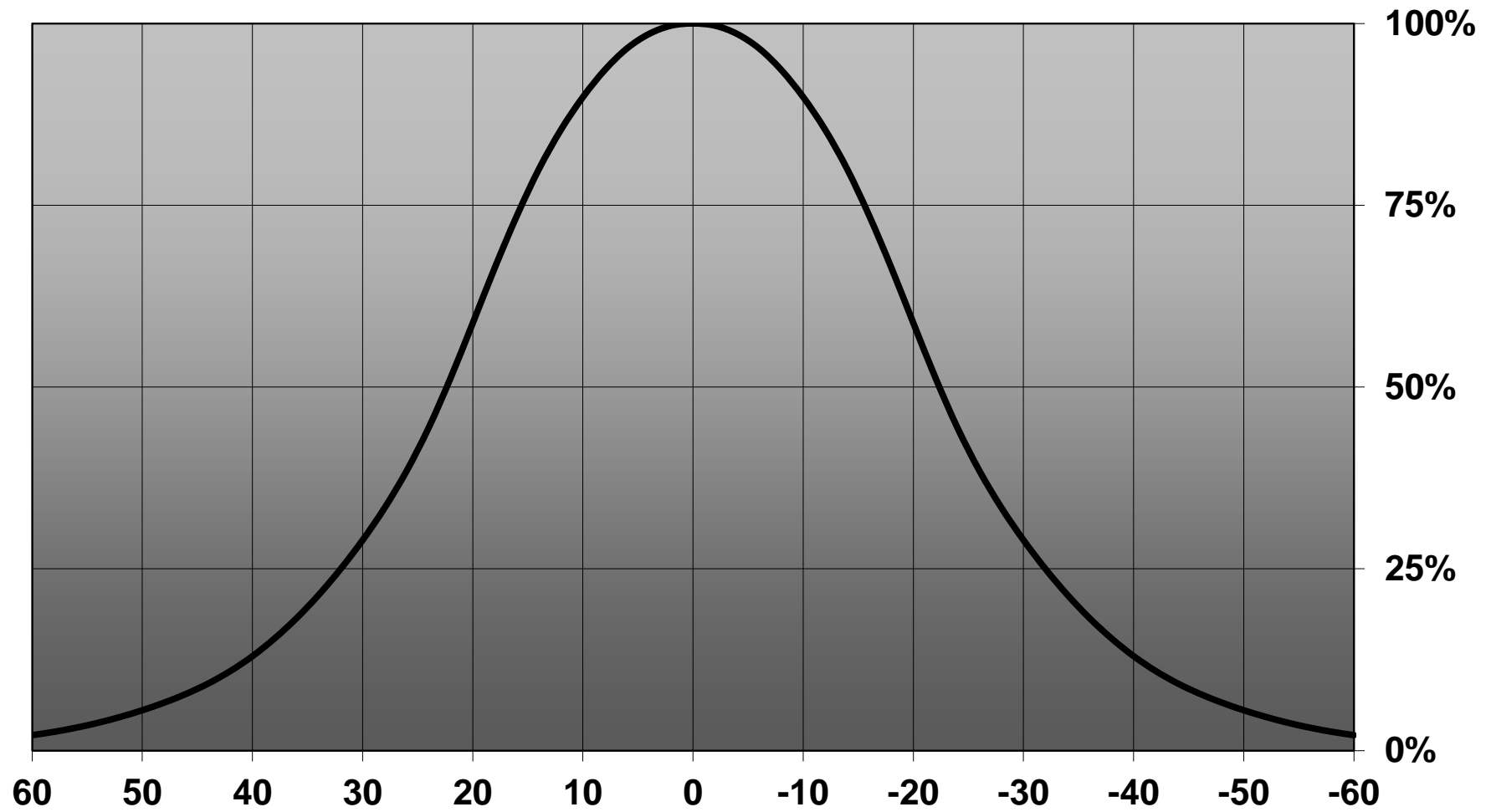

Relative intensity of C12502\_MIRA-WW (MT-G)

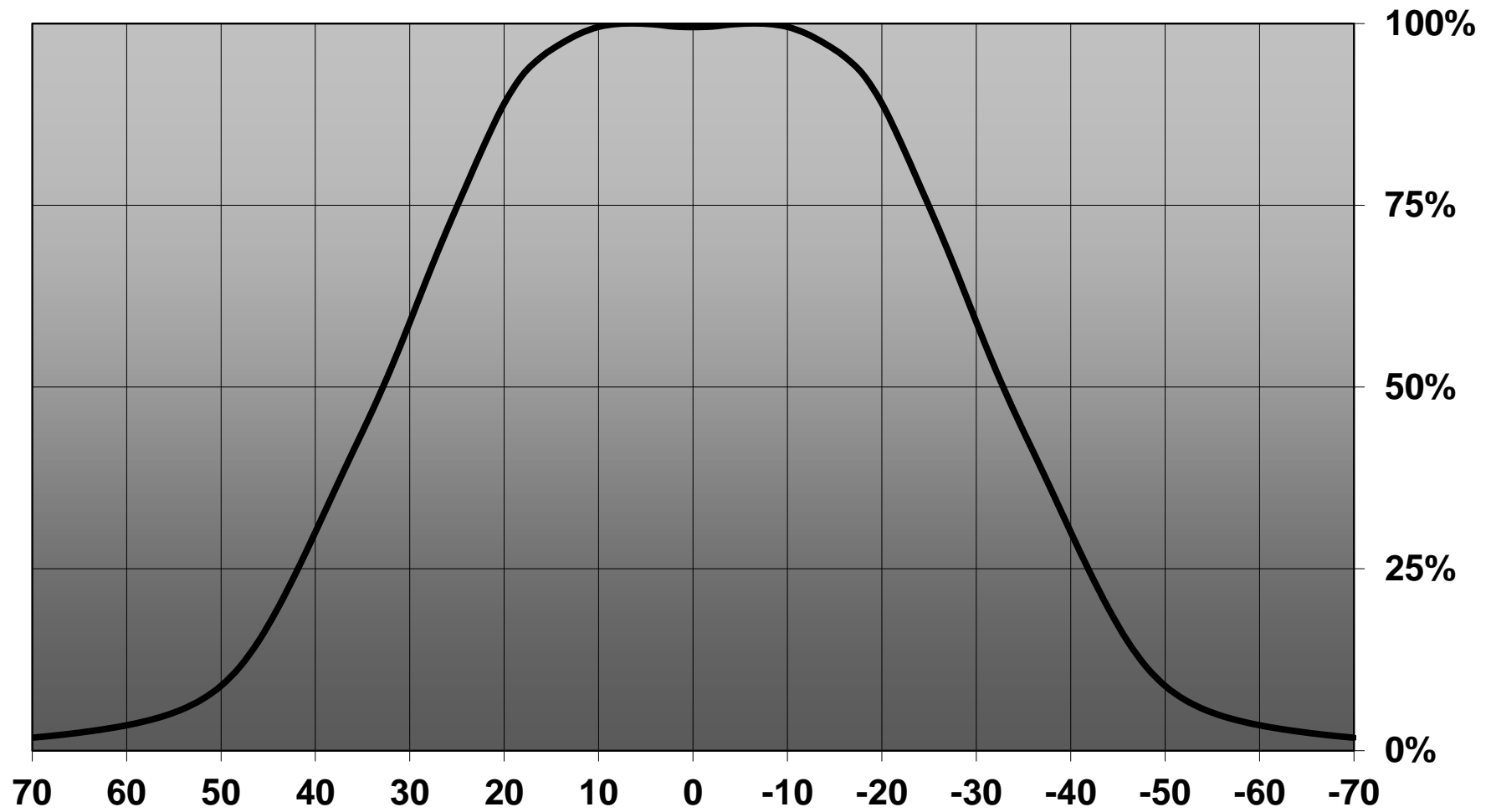

Relative intensity of CA12505\_MIRA-WW (MT-G)

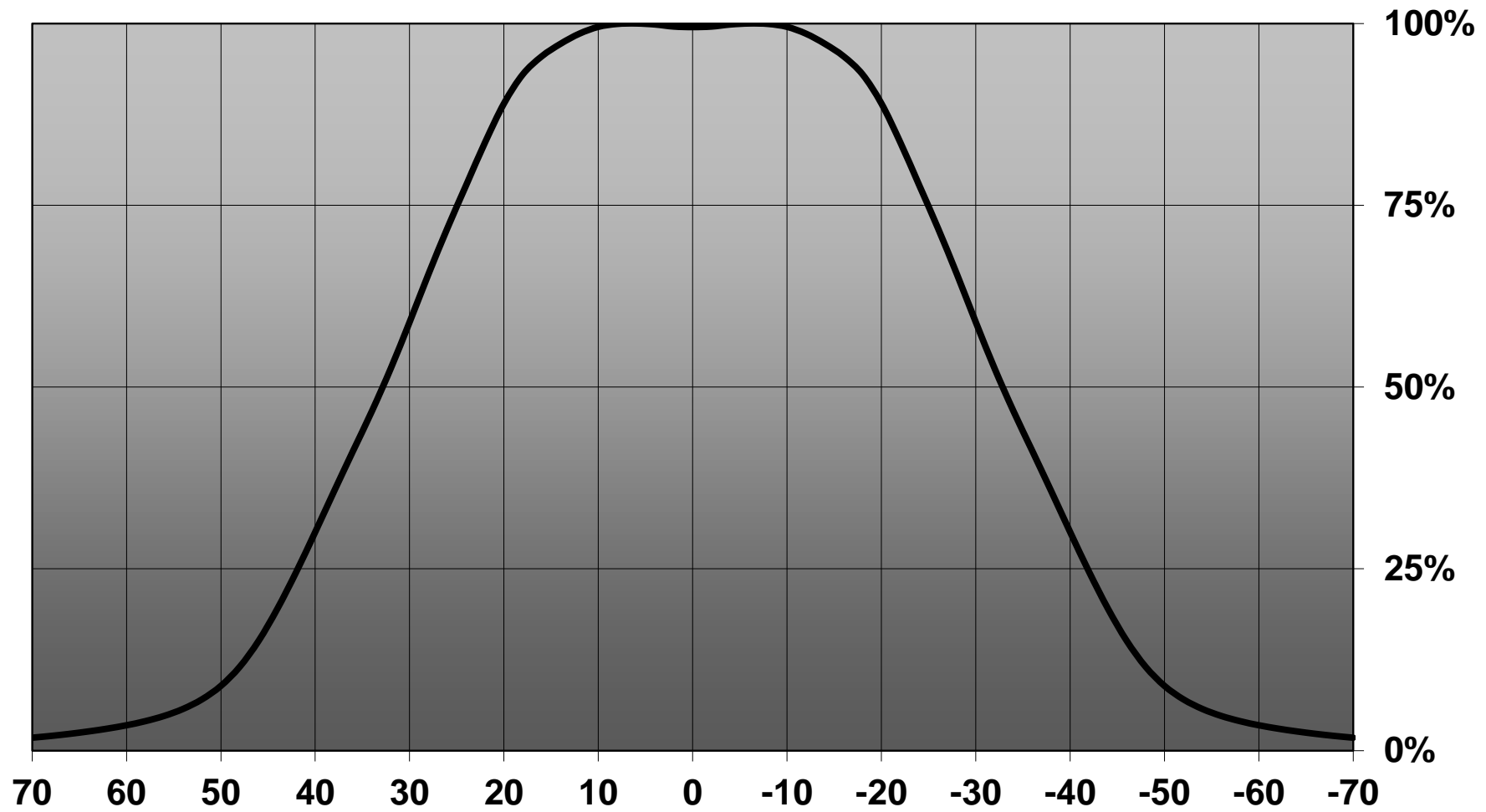

D

C

B

A

4

4

Bottom view

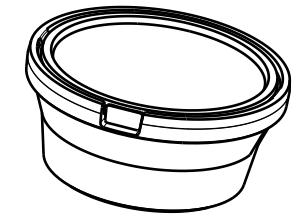
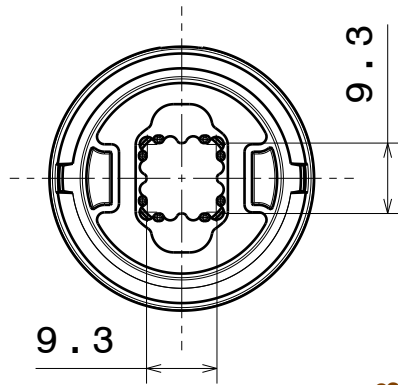

Isometric view

3

3

Front view

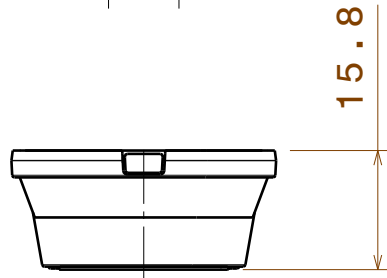

2

2

Top view

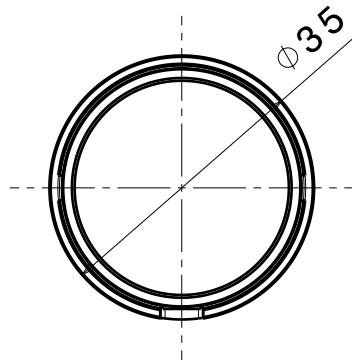

INDEX	PART NO	DESCRIPTION	MATERIAL	COLOUR
1	-	MIRA_MTG_ASSEMBLY	Lens and holder PC, Tape PU foam	

Tolerances if not otherwise shown  
According to DIN ISO 2768-1  
Linear measures:  
Up to 30mm class M, otherwise class C.  
According to DIN ISO 2768-2  
Form and position: class L

LEDiL

Ledil Oy  
Salorankatu 10  
FIN 24240 SALO  
Finland

THIRD ANGLE PROJECTION:

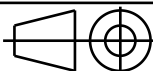

DRAWING TITLE

MIRA\_MTG\_ASSEMBLY

This drawing is the property  
of LEDiL Oy. It may not be  
reproduced, copied or  
communicated without a written  
agreement with LEDiL Oy."

SIZE PART NUMBER

A4

-

SCALE 1:1 WEIGHT

-

SHEET 1/1

D

A

1

Luminaire: Ledil Oy C12500-Mira-M (Cree MT-G 714lm @ 250mA) Efficiency=83%  
Lamps: 1 x Cree MT-G 714lm @ 250mA

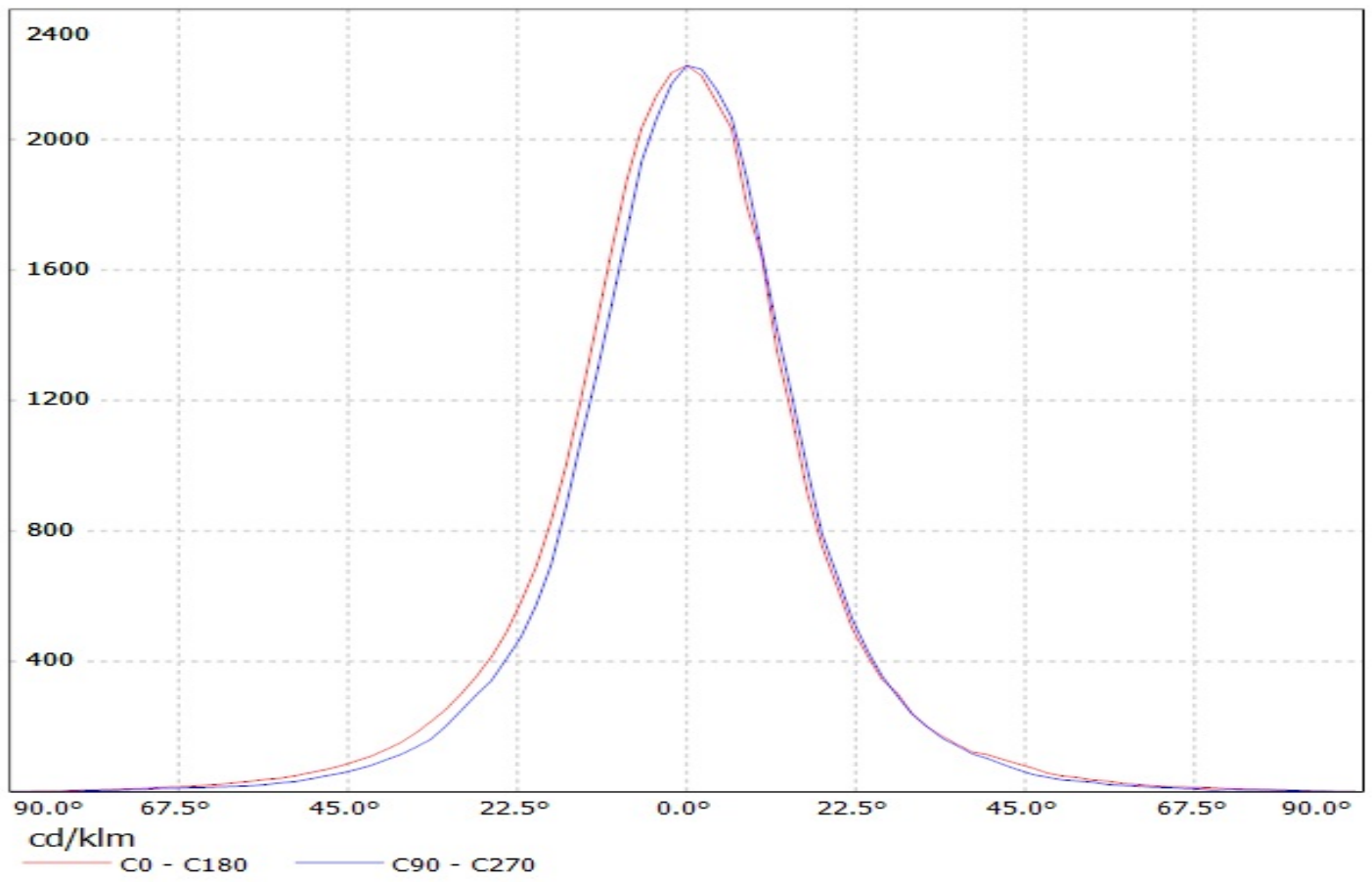



Luminaire: Ledil Oy C12501-Mira-W (Cree MT-G 714lm @ 250mA) Efficiency=80%  
Lamps: 1 x Cree MT-G 714lm @ 250mA

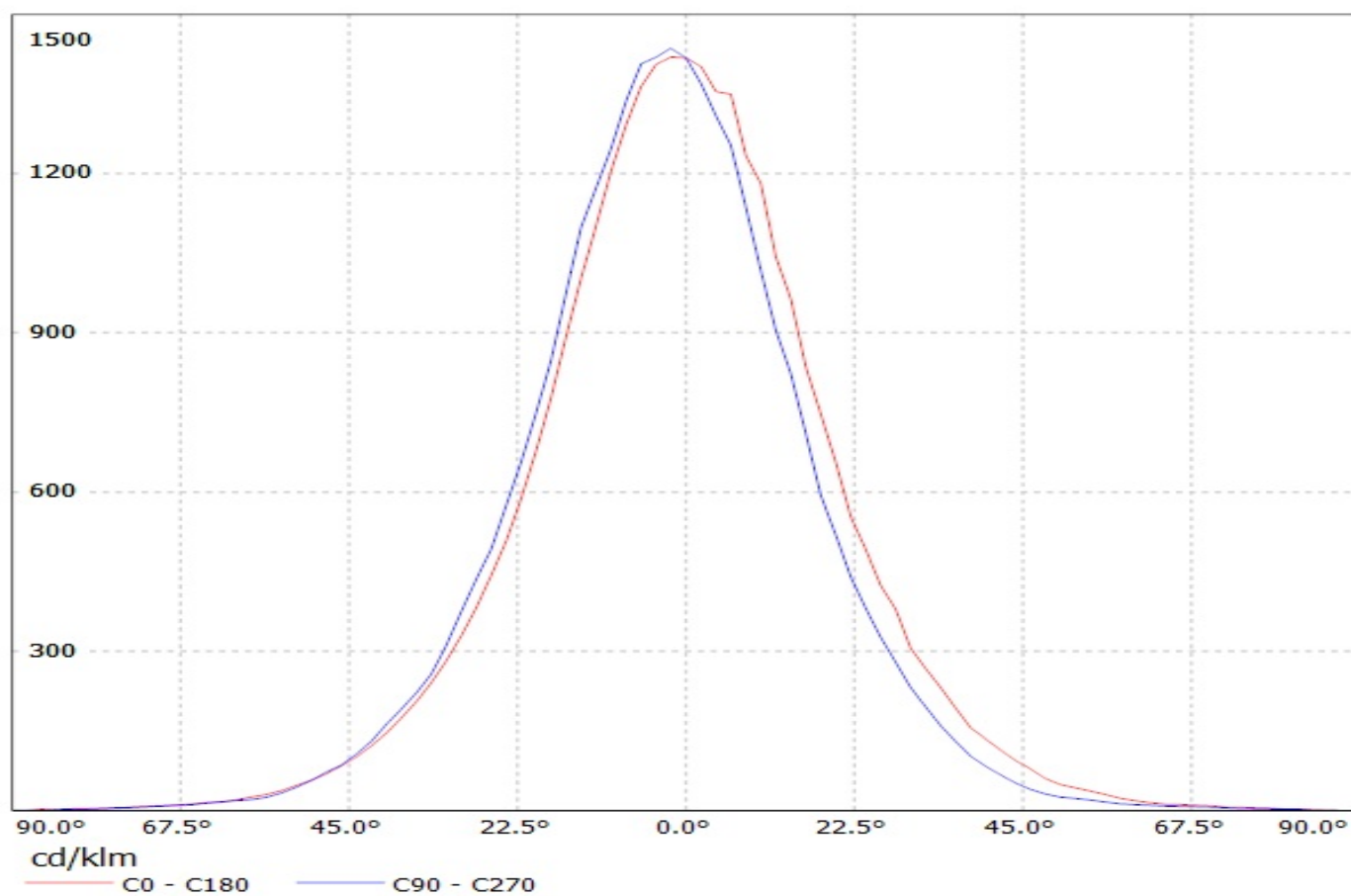

Luminaire: Ledil Oy C12502-Mira-WW (Cree MT-G 714lm @ 250mA) Efficiency=81%  
Lamps: 1 x Cree MT-G 714lm @ 250mA

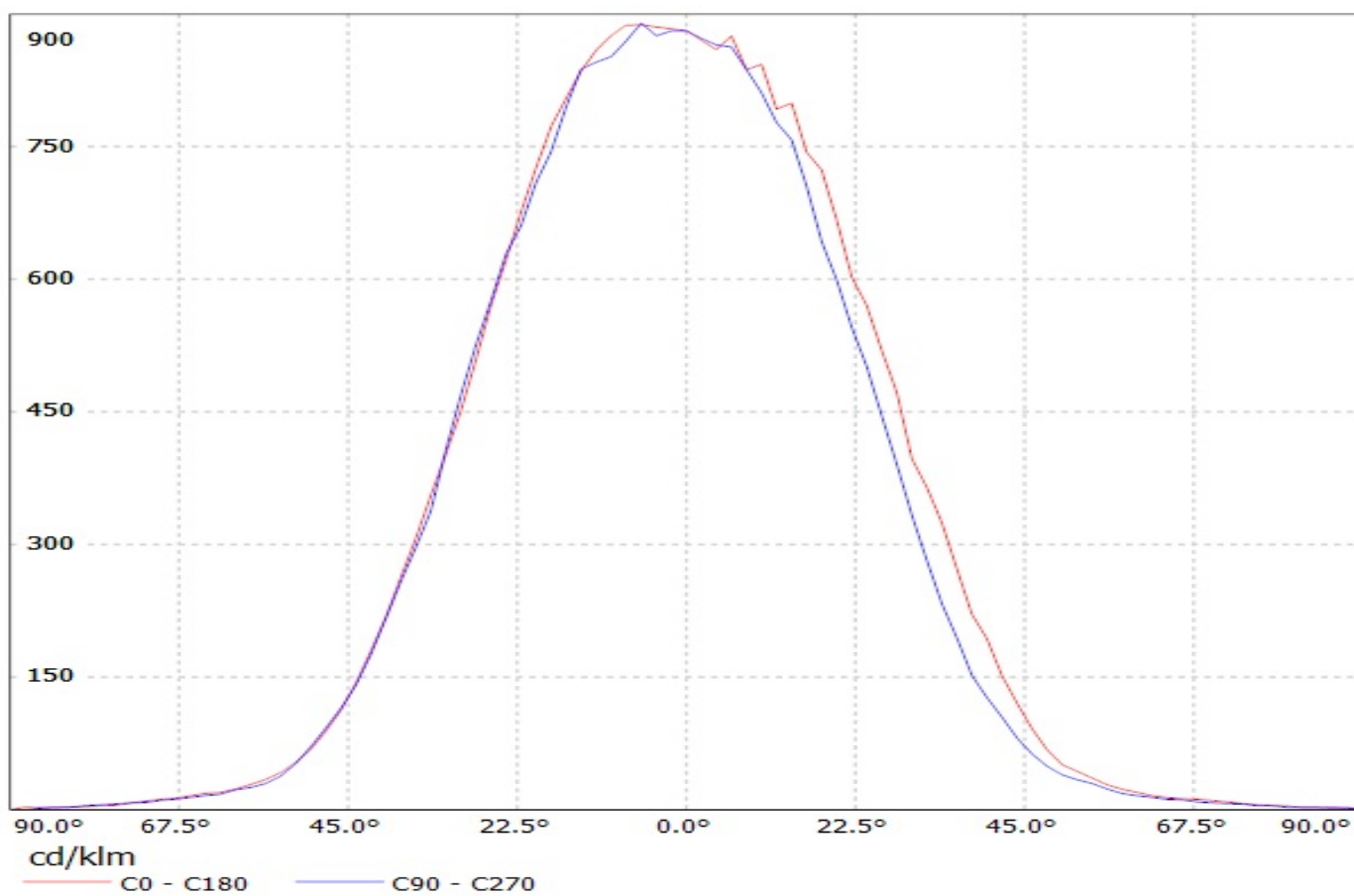

Luminaire: Ledil Oy C12500-Mira-M (Cree MT-G 714lm @ 250mA) Efficiency=83%  
Lamps: 1 x Cree MT-G 714lm @ 250mA

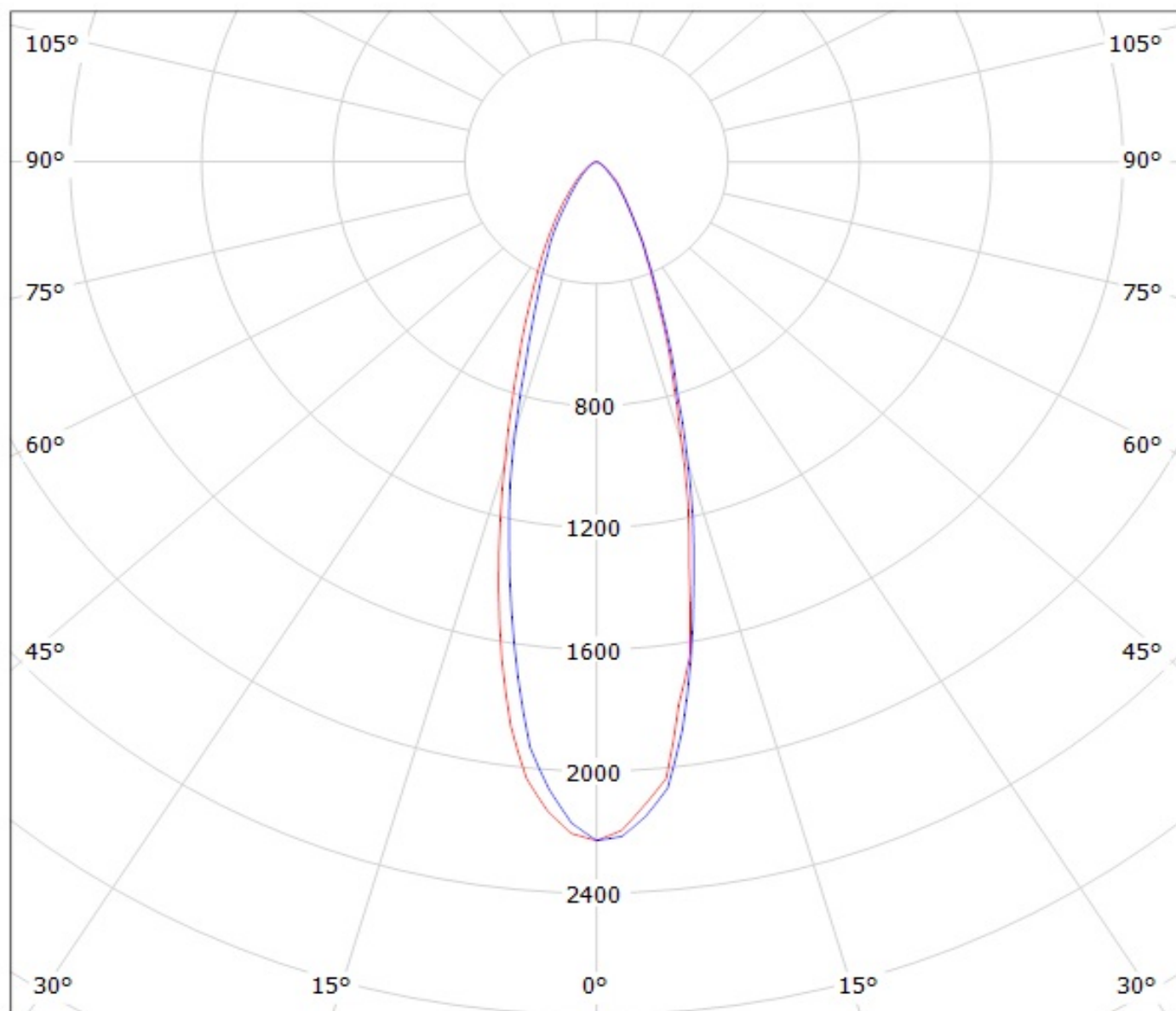

cd/klm

— C0 - C180

— C90 - C270

Luminaire: Ledil Oy C12501-Mira-W (Cree MT-G 714lm @ 250mA) Efficiency=80%  
Lamps: 1 x Cree MT-G 714lm @ 250mA

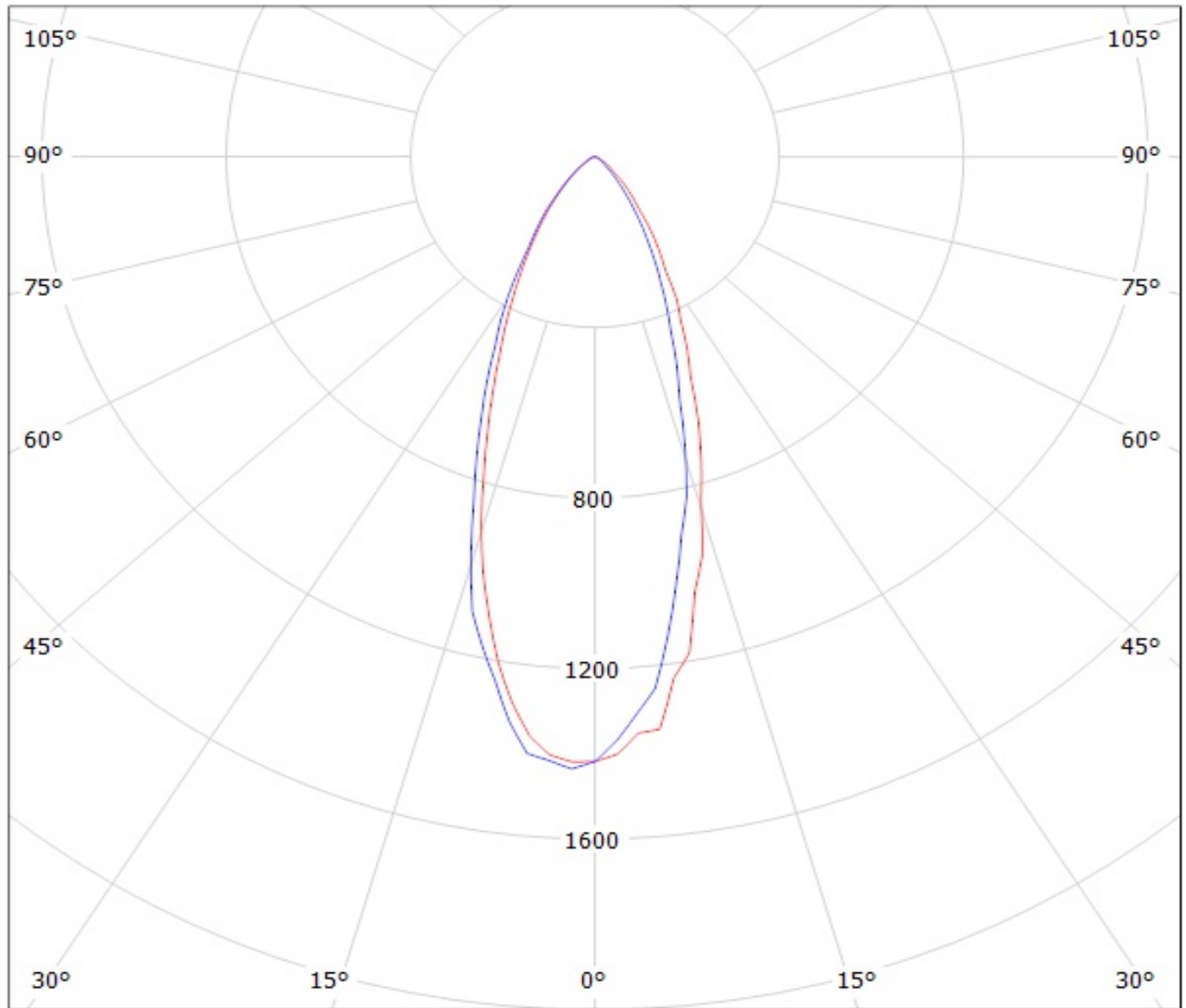

cd/klm

— C0 - C180    — C90 - C270

Luminaire: Ledil Oy C12502-Mira-WW (Cree MT-G 714lm @ 250mA) Efficiency=81%  
Lamps: 1 x Cree MT-G 714lm @ 250mA

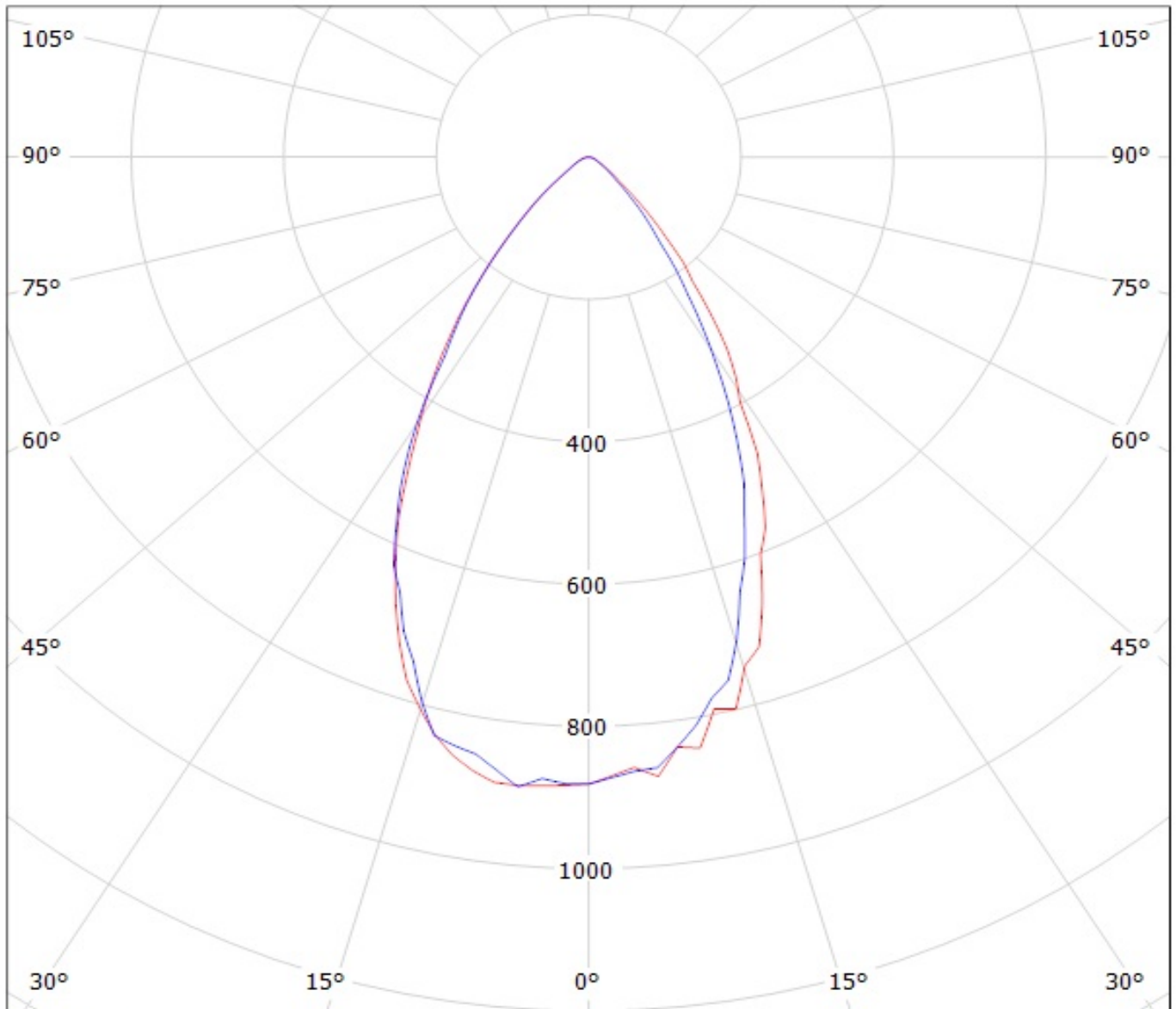

cd/klm  
— C0 - C180    — C90 - C270