

# VECO VANSONIC ENTERPRISE CO., LTD.

8F.,No.7,Lane 16, Sec.2, Szechwan Road, Panchiao, Taipei Hsien, TAIWAN.

TEL: +886-2-29626335

FAX: +886-2-29625220

E-MAIL: vansonic@ms4.hinet.net

1.	<b>MODEL:</b>	<b>36CS16FN</b> -M50BD(Black Mylar)-M50BT(Clear Mylar)
2.	Dimension	Outer Diameter <b>36</b> mm. Baffle Opening <b>32</b> mm.
		Height <b>Refer to Drawing</b> . Weight <b>7.5</b> Grams.
3.	Magnet	Materials <b>Rare Earth</b> . Size $\phi$ <b>12.5X 1.5</b> mm.
4.	Nominal Impedance	<b>16 Ohm</b> $\pm$ <b>15</b> % At <b>1000</b> Hz.
5.	Power Rating	Normal <b>500</b> mW. Maximum <b>1000</b> mW.
6.	Lowest Resonant Frequency	<b>600</b> $\pm$ <b>20</b> % Hz.
7.	Output Sound Pressure Level (S.P.L.)	<b>87</b> $\pm$ <b>3</b> db / 0.5 Watt 0.5 Meter.
		Average at <b>800, 1000, 1200, 1500</b> Hz.
8.	Frequency Range	<b>300</b> ~ <b>6500</b> Hz. Average SPL - 10 db.
9.	Distortion	<b>5</b> % Maximum At <b>1000</b> Hz. <b>500</b> mW.
10.	Abnormal Sound Test	Must Be Normal Test By <b>2.9</b> Volts. Sine Wave.
11.	Load Test	White Noise With Weighted Filter <b>2.9</b> Volts.(RMS) <b>24</b> Hrs.
12.	Polarity	Diaphragm shall move Forward when Apply a Positive DC.
		Current to the "+" or "Marked" Terminal.

## MOUNTING NOTICE

AT LEAST  
0.8mm  
FOR  
DIAPHRAGM  
MOVING

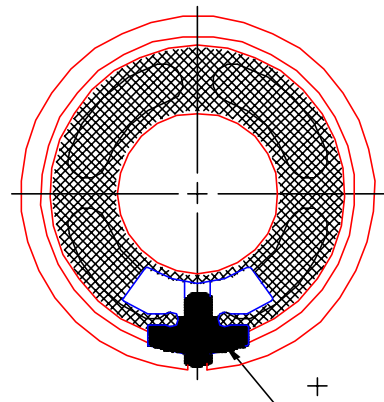
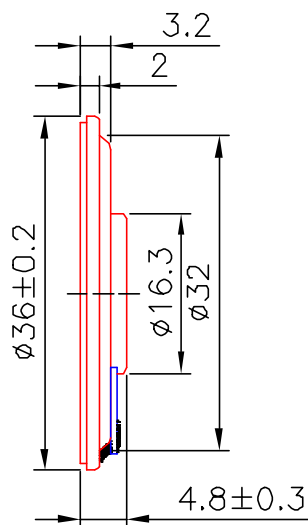
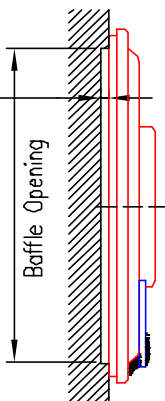

Unit : mm

Housing Material : METAL

36CS16FN-M50BD VOL:2.828V(0.5M) DIS:0.5M VANSONIC  
X:1.0000kHz \*Y:87.58dB ZA:Live Curve SSR Fund.

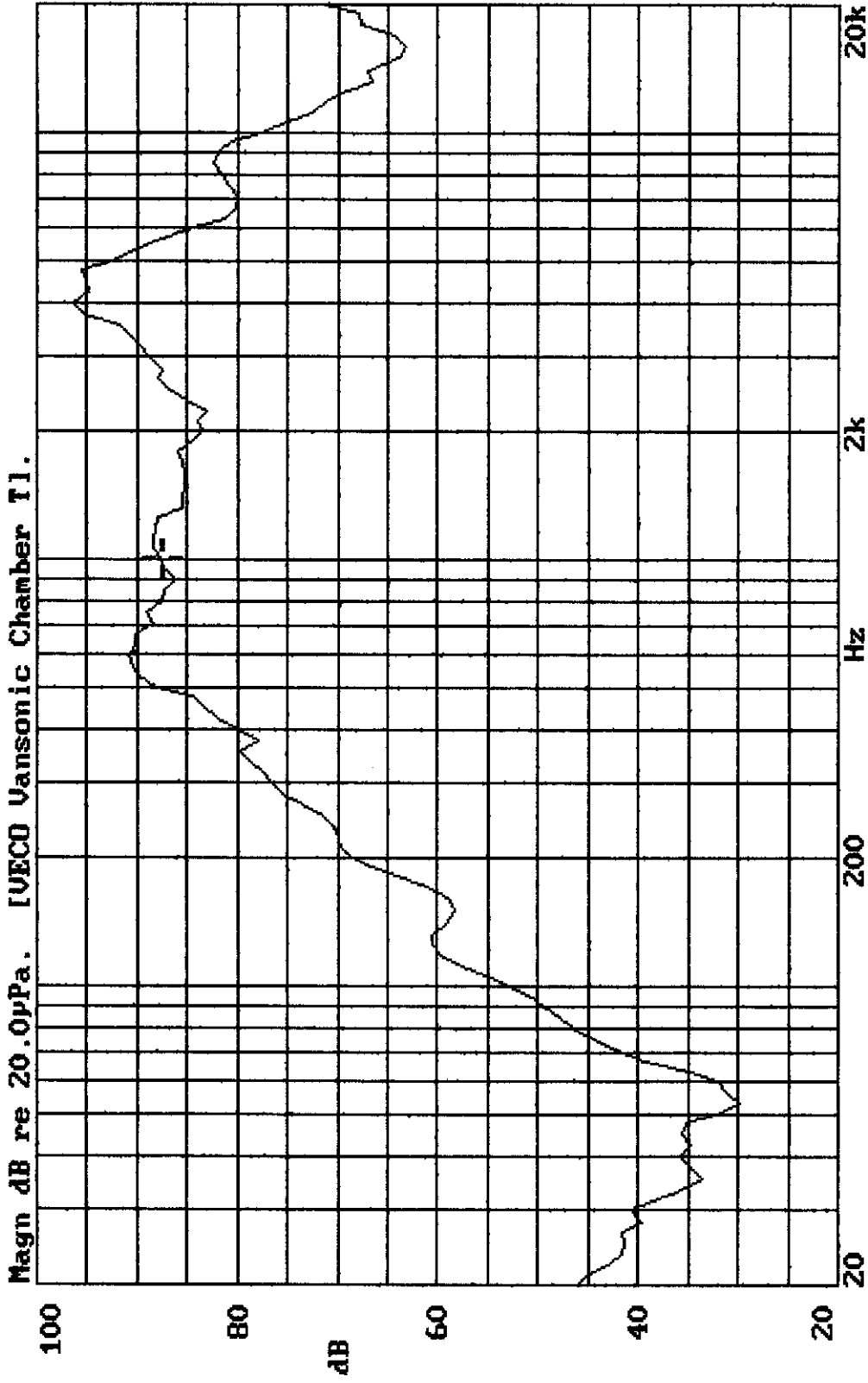

11-AUG-1999 15:44:17

Mode: SPEAKER

