

REV.	ECN NO.	DATE	SIGN	DESCRIPTION

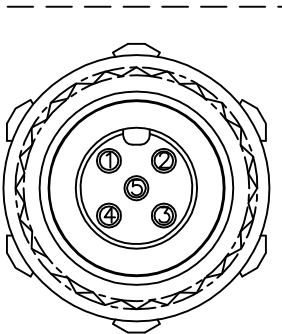

Pin Assignments
Front View

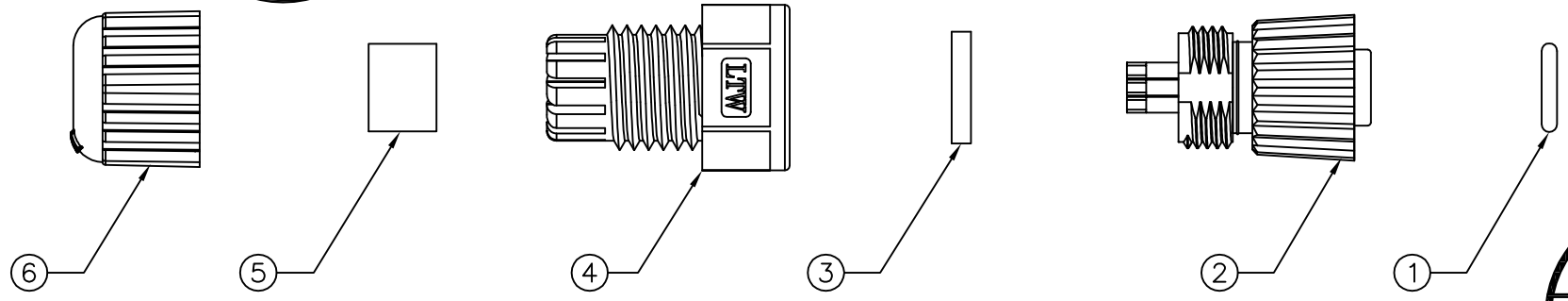
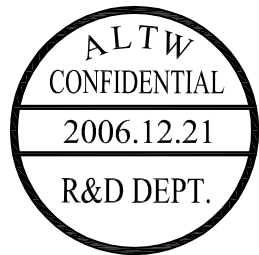
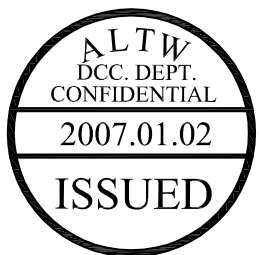
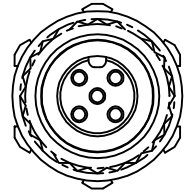
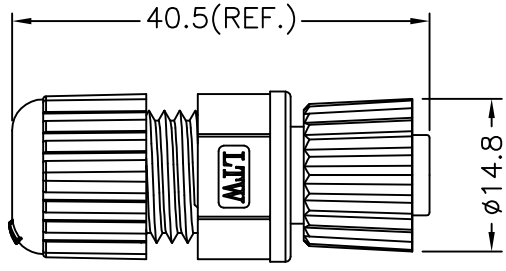

Conn.

Note:

- * @C Important Dimension To Check.
- * Waterproof Rate: IP68
- * Housing: Black, Nylon+GF
- * Pin: Copper Alloy, Gold Plated
- * Nut: Black, Nylon+GF
- * Ring: Green, Viton
- * Gasket: Black, EPDM
- * Clamp Ring: Black, Nylon
- * Sealing Nut: Black, Nylon
- * Seal: Black, EPDM
- * Seal For Cable OD: $\phi 4.5\text{mm} \sim \phi 6.5\text{mm}$

UNIT:mm 	TITLE M12 Conn, Assy Screw 5Pin F Conn. F Pin		<h1>Amphenol LTW</h1> <p>安費諾亮泰企業股份有限公司</p>	ITEM NO 12P-05BFFA-SL8001	DRAWN BY Patrick Ian Magat	DATE 2006/12/21
	TOLERANCE ± 0.5 mm	SCALE Free		SHEET 1 OF 1	DWG NO 12P-05BFFA-SL8001	CHECKED BY Alan MJ Sundo
1	2	3	4	5	6	7
REV. A	SIZE A4	@C :Inspection Item	CUSTOMER ALTW	APPROVED BY Max Hung	DATE 2006/12/22	8

THIS DOCUMENT IS SUBJECT TO CHANGE WITHOUT NOTICE. IT IS CONFIDENTIAL AND A PROPERTY OF Amphenol LTW. DISCLOSURE TO THIRD PARTY HAS TO BE AUTHORIZED BY Amphenol LTW.