



WIBC1801(3224)–Trimmer Ⓐ

4mm Square SMD Trimming potentiometer

Features

Surface Mount 4mm Square/ Multiturn

Cermet / Industrial / Sealed

Pick and place centering design , with flush adjustment

Electrical Characteristics

Standard Resistance Range:	10 to 1 megohms (see standard resistance table)
Resistance Tolerance:	±10% std. (tighter tolerance available)
Absolute Minimum Resistance:	1% or 2 ohms max. (whichever is greater)
Contact Resistance Variation:	3% or 3 ohms max. (whichever is greater)
Resolution:	Essentially Infinite
Insulation Resistance(500 vdc):	1,000 megohms min.
Dielectric Strength:	101.3 kPa 600 vac 8.5 kPa 250 vac
Effective Travel:	11 turns nom.

Environmental Characteristics

Power Rating (200 volts max.):	0.25 watt (70°C) , 0 watt (125°C)
Temperature Range:	-55°C to +125°C
Temperature Coefficient:	±100ppm/°C
Vibration:	98 m/s ² (1%Δ TR, 1%Δ VR)
Shock:	490 m/s ² (1%Δ TR, 1%Δ VR)
Load Life:	1,000 hours 0.25 watt @ 70°C (3%Δ TR, 3% or 3 ohm, whichever is greater, CRV)
Rotational Life:	200 cycles (3%Δ TR, 3% or 3 ohm, whichever is greater, CRV)
Thermal Shock:	5 cycles(2%Δ TR, 1%Δ VR)

Physical Characteristics

Torque:	25 mN • m max
Mechanical Stops:	Wiperidles
Wiper:	Set at 50% nominal

WIBC1801 (3224) –W DIMENSIONS

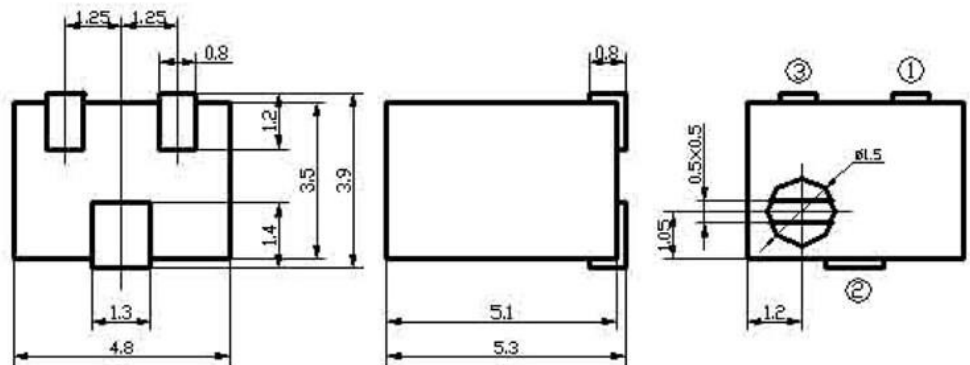

RECOMMENDED PCB LAYOUT

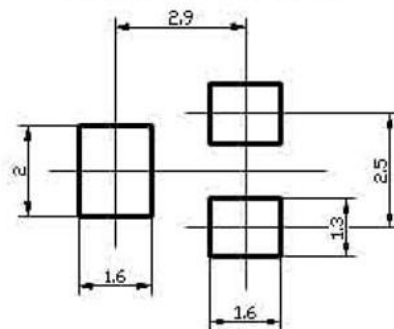

WIBC1801 (3224) -J DIMENSIONS

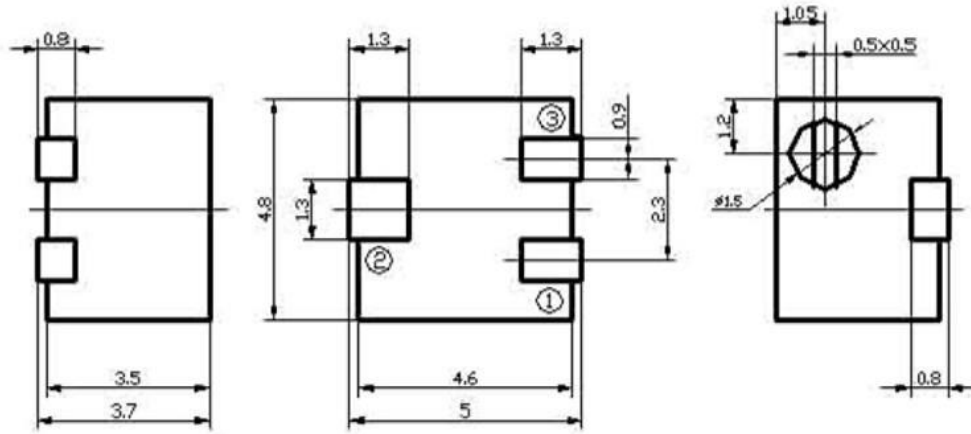

RECOMMENDED PCB LAYOUT

