

**P.C.B DIMENSION**  
(TOLERANCE±0.05)

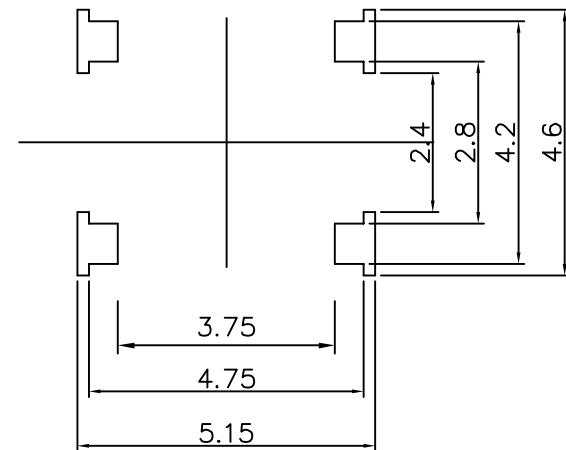

**NOTE**

1. RATING : DC 12V 50mA MAX
2. OPERATING FORCE : 160±50gf ,250±50gf
3. TRAVEL : 0.20 ±0.1 m/m
4. LIFE: 100,000 CYCLE

(20/1)

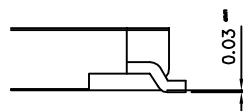

PART NO		PART NAME		Q'TY	MATERIAL		STANDARD	DISPOSITION	REMARKS
△				TRIGON-OMETRY	UNIT	SCALE	TACT SWITCH	DUST PROOF TYPE	MODEL
△				APPD	CHKD	10 / 1			
△						DSGD			
△									
△									
NO		CORRECTION							INT-1198S05B