

SPECIFICATIONS

Circuit	:SPST
Current rating	:10mA min./100mA max.
Voltage rating	:2V DC min./30V DC max.
Dielectric withstanding voltage	:500VAC for 1 minute
Contact resistance	:50mΩ Max. (Initial)
Insulation resistance	:100MΩ Min.
Operating force	:600±100gf
Total travel	:1.5±0.4mm
Operating life:	:1,000,000 cycles Min
Bounce time:	: ≤ 1ms
Operating speed	100 mm/s(3.94/s)
Solder specifications	:260°C for 5 seconds
Operating temperature	:- 40°C ~ + 85°C
Protection class	: IP40

MATERIAL:

Base : PA+GF,UL rated:94 V-2 Min;
 Cap: POM ;
 Terminal: Brass,Silver plated;

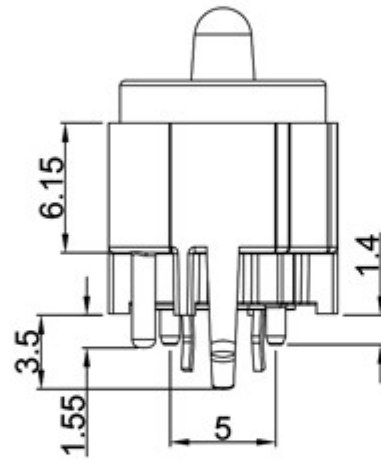
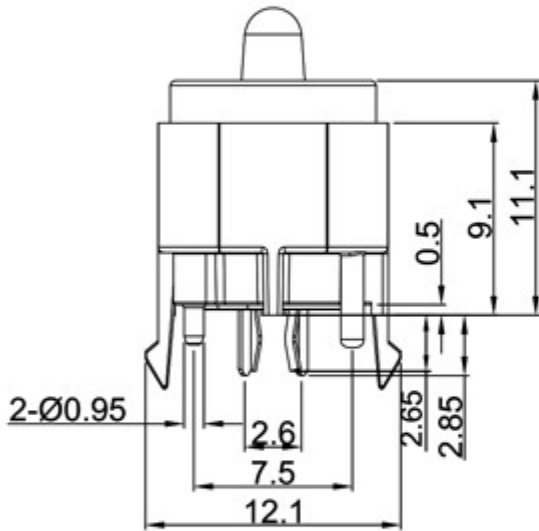

CIRCUIT

P.C.B. LAYOUT

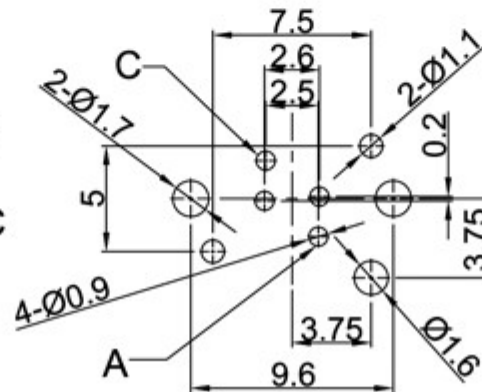
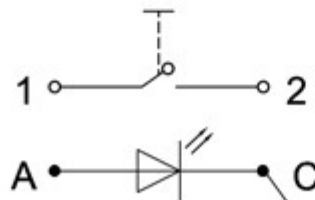
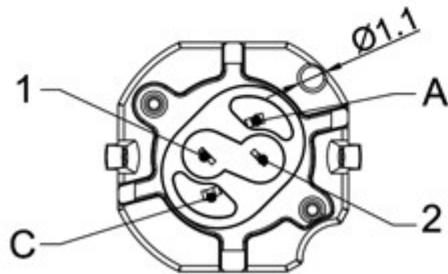

LED SPECIFICATIONS						
G1	Bright Green 翠绿色	2.8	--	3.4	20	100
W	White 白色	2.8	--	3.4	20	100
U	Blue 蓝色	2.8	--	3.4	20	100
Y	Yellow 黄色	1.8	--	2.4	20	100
G	Green 黄绿色	1.8	--	2.4	20	100
R	Red 红色	1.8	--	2.4	20	100
灯发光颜色(X)	最小一般最大	最大操作电流	最大脉冲电流			
Emitted Color (X)	顺向电压(V)	(mA)	(mA)			