

RoHS Compliance

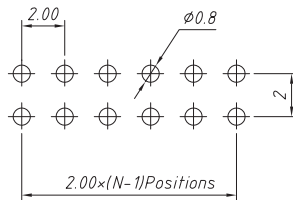
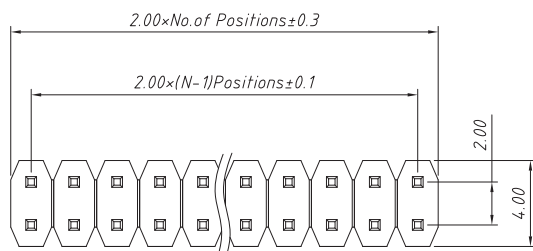

Recommended P.C.B Hole Layout

Material:
 Standard: PA6T
 Contact: Brass
 Insulator: Polyester, UL94V-0

Electrical Characteristics:
 Rated Current: 1.5AMP
 Contact Resistance: 20mΩ Max
 Withstand Voltage: 500V AC/DC
 Insulator Resistance: 1000MΩ Min

Mechanical
 Operating Temperature: -40°C ~ +105°C
 Max. Processing Temp: 240°C for 30-60 seconds
 (260°C for 10 seconds)

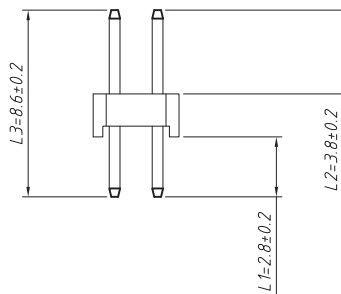
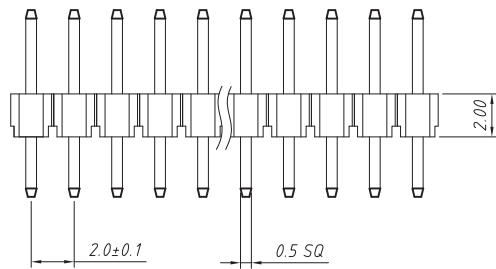

Dimension antitheses list (mm)

| ITEM | L1 | L2 | L3 | Plastic Height |
|-------------|------|------|------|----------------|
| Standard | 2.80 | 3.80 | 8.60 | 2.00 |
| Nonstandard | --- | --- | --- | --- |

| | | | |
|-------------------|------------|-------------------|-------------------------------------|
| ANGLE TOLERANCE | PROJECTION | Description: | 2.00mm Pin Header |
| ±3° | | | Double layer, Straight Pin, 2xN Pin |
| GENERAL TOLERANCE | UNITS | mm | CONN THERM |
| x.x ±0.30 | SHEET SIZE | A4 | |
| x.xx ±0.20 | Draw: | Daniel 2018-07-10 | |
| x.xxx ±0.10 | Check: | Daniel 2018-07-10 | |