

REV.	EON NO.	DATE	SIGN	DESCRIPTION

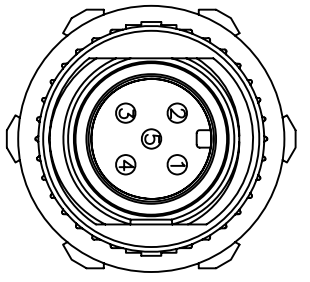

Pin Assignments
Front View

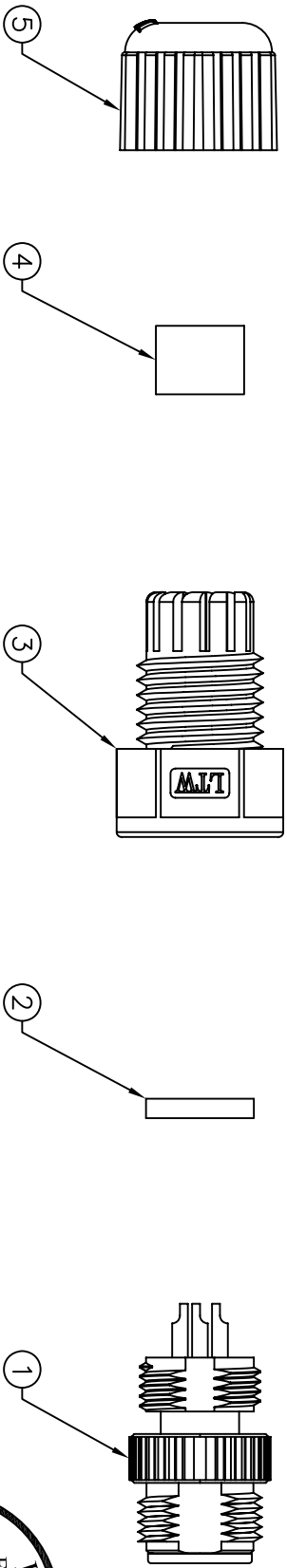
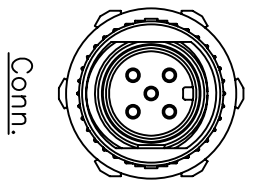
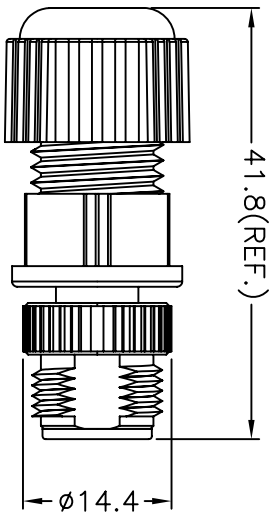

- Note:
- * @Important Dimension To Check.
 - * Waterproof Rate: IP68
 - * Housing: Black, Nylon+GF
 - * Pin: Copper Alloy, Gold Plated
 - * Nut: Zinc Alloy, Nickel Plated
 - * Gasket: Black, EPDM
 - * Clamp Ring: Black, Nylon
 - * Sealing Nut: Black, Nylon
 - * Seal: Black, EPDM
 - * Seal For Cable OD: $\phi 4.5\text{mm} \sim \phi 6.5\text{mm}$

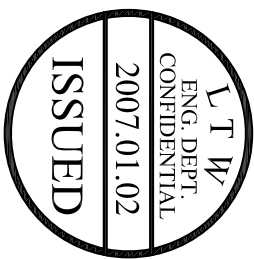

UNIT:mm		TITLE		ITEM NO		DRAWN BY		DATE	
TOLERANCE		Assy Screw 5Pin M Conn M Pin		LTW12-05BMMA-SL8001		Jason Manas		2006/12/21	
$\pm 0.5 \text{ mm}$		SCALE		DWG NO		CHECKED BY		DATE	
		Free		LTW12-05BMMA-SL8001		Alan MJ Sundo		2006/12/21	
		REV. A		SIZE A4		SHEET 1 OF 1		APPROVED BY	
				: Inspection Item		Max Hung		DATE	
								2006/12/21	
								8	

LTW
亮泰企業股份有限公司